

For Automotive parts finder on eldonjames.com
click link below



<http://eldonjames.com/frames/matframeAutoPartsSelector.html>



Automotive Fittings
Industrial / Utility Fittings

Eldon James

A large, dark-themed collage of various fittings. It includes several 3D renderings of different types of fittings: a T-junction fitting, a plug with a red O-ring, a hexagonal fitting, and a Y-junction fitting. There is also a technical drawing showing a cross-section of a fitting with dimensions. The background features abstract green light streaks. The text 'Automotive Fittings' and 'Industrial / Utility Fittings' is centered in a white box, and the 'Eldon James' logo is in the bottom right corner.

Assembled Panel Mount Fitting - with O-Ring and nut.
Panel Mount Adapter Fittings: Pages 53, 68-69

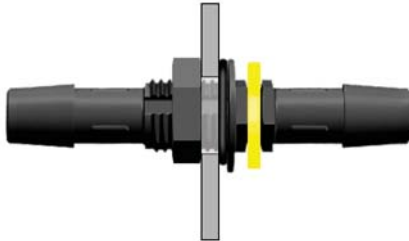

Assembled Bulkhead Fitting - with O-Ring, nut and color-coded Clip Ring. Bulkhead Adapter Fittings: Page 52

New 1/16" NPT Threads - Miniature Adapters, Miniature Threaded Elbows, Miniature Threaded Tees and Custom Fittings.



Oetiker Stainless Steel Clamps - An expanded range of sizes and configurations are now available with quantity discounts: Pages 132-133



ISO 9001-2000 Certified



Automotive Approvals:

Eldon James part numbers with the BN suffix are molded from materials that have the following approvals:

- GM.....GMP.PA66.062(N)
- Ford.....(ESA-M4D379-A&B) WSK-M4D666-A
- DCX.....DB41 CPN2565
- Delphi.....DCM5150
- Other Approvals: SAEJ1639PA0172, ASTMD4066PA0181**



Eldon James part numbers with the **GFBN** suffix are molded from materials that have the following approvals:

- GM.....GMP.PA66.013
- Ford.....WSK-M4D663-A
- Other Approvals: ASTMPA12G35**



Contents



Materials Quick Reference Guide.....	Page 2-3
Antimicrobial (Protected) Fittings	Page 4-11
Natural Materials Fittings - Natural Kynar®, Natural Polypropylene, Natural Nylon, HDPE.....	Page 12-39
Natural Materials - BSPT Fittings..... British Standard Pipe Thread	Page 36-39
Schedule 80 Fittings (high pressure).....	Page 40-41
Stainless Steel Fittings	Page 42-45
Swivel Disconnect Fittings	Page 46-48
Automotive Fittings - Black Nylon, Glass-Filled Black Nylon.....	Page 49-66
Automotive Materials - BSPT Fittings..... British Standard Pipe Thread	Page 64-66
Industrial / Utility Fittings - Gray Kynar®, White Polypropylene, White Nylon, Black Nylon.....	Page 68-93
Industrial Materials - BSPT Fittings..... British Standard Pipe Thread	Page 90-93
Miniature Fittings Quick Reference Guide	Page 96-104
Miniature Custom Fittings Options.....	Page 105-112
Luer and Medical Fittings	Page 113-116
Tubing - Flexible Polyethylene.....	Page 120-123
Flexible Polyethylene - (Antimicrobial Protected).....	Page 124-125
Tubing - Soft Medical.....	Page 126-127
Soft Medical - (Antimicrobial Protected).....	Page 126-127
Tubing - Braid Reinforced PVC • Braid Reinforced Polyurethane.....	Page 128
Tubing - Fuel Line • Clear PVC • Clear Polyurethane.....	Page 129-130
Clamps - Plastic • Stainless Steel.....	Page 131-135
Barb Sizes - Specifications and Reference Charts	Page 67
Kits - General Purpose • Automotive Heater Hose • Automotive Fuel Line.....	Page 136-138
Chemical Resistance Charts	Page 139-142
Terms and Conditions of Sale	Page 143

Product Locator

Adapters 4, 12-15, 51-52, 68-70	Elbows-Threaded 8, 22-25 57-58, 76-78	Tees-Reduction 30-31, 62, 84-85
Adapters-Bulkhead 14-15, 52	Garden Hose Adapter 24-25, 59, 79	Tees-Threaded 10, 32-35 63-64, 86-89
Adapters-Panel Mount 16-17, 53, 68-69	Luer Fittings 113-116	Y-Connectors 11, 34-35, 64, 88-89
BSPT Threaded 36-39, 65-66, 90-93	Miniature Fittings 96-112	
Couplers 5, 16-17, 53, 71	Nipples / Plugs 24-27, 59-60, 79-83	Tubing 117-130
Couplers-Reduction 6, 18-19 54-55, 72-73	Port Plates 28	Clamps 131-135
Crosses 18-19, 54-55, 72-73	Stainless Steel Fittings 42-45	Kits 136-138
Elbows 7, 20-21, 56-57, 74-75	Swivel Disconnects 46-48	Fittings Certified to NSF/ANSI 51 & 61 4-39
Elbows-Reduction 20-21, 57, 74-75	Tees 9, 29, 61, 82-83	

Natural Materials Quick Reference



Certified to NSF/ANSI 51 & 61

Most Natural Nylon, HDPE, and Natural Kynar® **AG fittings** are NSF/ANSI 51 and 61 Certified, with the exception of Ys which are certified to NSF/ANSI 61 only.



Antimicrobial (Protected) (AG)

RoHS Compliant

Available in Nylon, Kynar®, Polypropylene and HDPE. These fittings incorporate natural silver ion protection to guard against microbial colonization and bio-film formation on their surfaces.

Natural Polypropylene AGNP fittings are not NSF/ANSI 51 & 61 Certified



Certified to NSF/ANSI 51 & 61

A large number of Eldon James Natural Kynar® Fittings are Certified to NSF/ANSI 51 and 61. If certificates are required, please make your request at the time the order is placed.

USP CLASS VI



Natural Kynar® (NK)

RoHS Compliant

Animal Derivative Free

Temperature Range -80°F to 226°F • Pressure 260 psi @ 70°F. NK Material can be autoclaved to 285°F (140°C) and meets **USP Class VI** requirements.

Generally, chemically resistant to: most acids • salts • weak bases • halogenated solvents • alcohols • fluids of gas streams in excess of 212 °F • nuclear and UV radiation • oxidants • ozone • deionized water.



Certified to NSF/ANSI 51 & 61

A large number of Eldon James Natural HDPE Fittings are Certified to NSF/ANSI 51 and 61. If certificates are required, please make your request at the time the order is placed.



High Density Polyethylene (HDPE)

RoHS Compliant

When used unmodified for the manufacture of food contact articles, HDPE complies with FDA 21 CFR177.1520.

HDPE also has various applications for use in medical products and devices. It has excellent resistance to chemicals and has an aesthetically pleasing, glossy white finish. HDPE is a softer material than Nylon and much softer than Kynar®.



Certified to NSF/ANSI 51 & 61

A large number of Eldon James Natural Nylon Fittings are Certified to NSF/ANSI 51 and 61. If certificates are required, please make your request at the time the order is placed.



Natural Nylon (NN)

RoHS Compliant

Temperature Range -50°F to 275°F • Pressure 125 psi @ 70°F

A 6/6 nylon, which exhibits strength, moderate stiffness, high impact resistance and good tensile strength. Resistant to fuels, lubricants and many chemicals, but vulnerable to attack by phenols, strong acids and oxidizing agents.

USP CLASS VI

Natural Polypropylene NP and PP materials meet USP Class VI requirements. If certificates are required, please make your request at the time the order is placed.

Polypropylene fittings are not NSF/ANSI 51-61 Certified

RoHS Compliant

(PP) Material - Animal Derivative Free



Natural Polypropylene (NP) *(PP)

Temperature Range -9°F to 150°F • Pressure 125 psi @ 70°F
FDA Compliant • Meets **USP Class VI** requirements (US Pharmacopoeia)

Highly resistant to solvents and chemicals • Resistant to water and other inorganic environments • Resists most strong mineral acids and bases, but like the other polyolefins, it is subject to attack by oxidizing agents.

* PP suffix represents natural polypropylene that contains no components of animal origin

Automotive & Industrial Materials Quick Reference

RoHS Compliant

Automotive Approvals



Black Nylon (BN)

Temperature Range -50°F to 275°F • Pressure 150 psi @ 70°F

Made from 6/6 nylon - exhibits strength, moderate stiffness, high service temperature, high impact resistance and tensile strength. Resistant to fuels, lubricants and many chemicals, but vulnerable to attack by phenols, strong acids and oxidizing agents. Used in fuel line, vacuum systems and general purpose applications: automotive industry approvals.

RoHS Compliant

Automotive Approvals



Glass-Filled Black Nylon (GFBN)

Temperature Range -50°F to 275°F • Pressure 150 psi @ 70°F
Heat Deflection Temperature - ASTM D64: 475°F (246°C) @ 264 psi

GFBN is a standard material used in automotive and marine under-the-hood, heater and coolant applications. GFBN's enhanced impact resistance results from inclusion of uniformly dispersed glass fibers that add strength to the resin: automotive industry approvals.

RoHS Compliant



Stainless Steel (SS)

Fittings produced with 316L alloy perform well in high temperature, harsh physical environments. 316L molybdenum bearing stainless steel has excellent impact and chemical resistance, but is less resistant than other types of stainless steel to highly oxidizing acids, such as nitric acid. The material has wide application in pharmaceutical and dairy processing and is used extensively in brewery, beverage and bio-process industries.

RoHS Compliant



White Polypropylene (WP)

Temperature Range -9°F to 150°F • Pressure 125 psi @ 70°F

White Polypropylene has the same physical and chemical resistance properties as Natural Polypropylene, but is less expensive. WP fittings contain a percentage of recycled material sourced from our Natural Polypropylene, virgin material production runs. White Polypropylene fittings are manufactured to the same tolerances and quality standards as our Natural Polypropylene fittings - WP is not a USP Class VI material.

RoHS Compliant



White Nylon (WN)

Temperature Range -50°F to 275°F • Pressure 125 psi @ 70°F

White Nylon has the same chemical and physical properties as Natural Nylon. WN fittings contain a percentage of recycled material sourced from our Natural Nylon, virgin material production runs. White Nylon fittings are manufactured to the same tolerances and quality standards as our Natural Nylon fittings - White Nylon is not NSF certified.

RoHS Compliant



Gray Kynar (PVDF)

Temperature Range -80°F to 226°F • Pressure 260 psi @ 70°F

Gray PVDF fittings exhibit the same physical and chemical resistance properties as Natural Kynar®; however, these fittings contain a percentage of recycled material sourced from our Natural Kynar®, virgin material production runs. For applications that do not require lot traceability, NSF certification or material that meets USP Class VI requirements, PVDF fittings represent an excellent value. Gray PVDF fittings are manufactured to the same tolerances and quality standards as Natural Kynar® fittings.

DISCLAIMER

Data presented for properties of materials, pressure, temperature and chemical resistance is for reference only. Customer applications and conditions of use are beyond our control; therefore, it is imperative that customers test Eldon James products in their specific application to determine suitability. All information is provided without implied or expressed warranty or guarantee, and none of the information provided constitutes a recommendation or endorsement of any kind by Eldon James Corporation.



Black Nylon • RoHS
Good Tensile Strength

Adapters



NPT 1/8" to 1"

Glass-Filled Black Nylon • RoHS
Excellent Impact Resistance



Black Nylon

Glass-Filled Black Nylon

Thread - Barb	Part Number	•	•	•	Thread - Barb	Part Number	•	•	•
1/8" NPT • 1/16"	A2-1 BN	•	•	•	1/8" NPT • 1/16"	A2-1 GFBN	–	–	–
1/8" NPT • 3/32"	A2-1.5 BN	•	•	•	1/8" NPT • 3/32"	A2-1.5 GFBN	–	–	–
1/8" NPT • 1/8"	A2-2 BN	•	•	•	1/8" NPT • 1/8"	A2-2 GFBN	•	•	•
1/8" NPT • 5/32"	A2-2.5 BN	•	•	•	1/8" NPT • 5/32"	A2-2.5 GFBN	•	•	•
1/8" NPT • 3/16"	A2-3 BN	•	•	•	1/8" NPT • 3/16"	A2-3 GFBN	•	•	•
1/8" NPT • 1/4"	A2-4 BN	•	•	•	1/8" NPT • 1/4"	A2-4 GFBN	•	•	•
1/8" NPT • 5/16"	A2-5 BN	•	•	•	1/8" NPT • 5/16"	A2-5 GFBN	•	•	•
1/8" NPT • 3/8"	A2-6 BN	•	•	•	1/8" NPT • 3/8"	A2-6 GFBN	•	•	•
1/4" NPT • 1/8"	A4-2 BN	•	•	•	1/4" NPT • 1/8"	A4-2 GFBN	•	•	•
1/4" NPT • 5/32"	A4-2.5 BN	•	•	•	1/4" NPT • 5/32"	A4-2.5 GFBN	•	•	•
1/4" NPT • 3/16"	A4-3 BN	•	•	•	1/4" NPT • 3/16"	A4-3 GFBN	•	•	•
1/4" NPT • 1/4"	A4-4 BN	•	•	•	1/4" NPT • 1/4"	A4-4 GFBN	•	•	•
1/4" NPT • 5/16"	A4-5 BN	•	•	•	1/4" NPT • 5/16"	A4-5 GFBN	•	•	•
1/4" NPT • 3/8"	A4-6 BN	•	•	•	1/4" NPT • 3/8"	A4-6 GFBN	•	•	•
1/4" NPT • 1/2"	A4-8 BN	•	•	•	1/4" NPT • 1/2"	A4-8 GFBN	•	•	•
3/8" NPT • 1/4"	A6-4 BN	•	•	•	3/8" NPT • 1/4"	A6-4 GFBN	•	•	•
3/8" NPT • 5/16"	A6-5 BN	•	•	•	3/8" NPT • 5/16"	A6-5 GFBN	•	•	•
3/8" NPT • 3/8"	A6-6 BN	•	•	•	3/8" NPT • 3/8"	A6-6 GFBN	•	•	•
3/8" NPT • 1/2"	A6-8 BN	•	•	•	3/8" NPT • 1/2"	A6-8 GFBN	•	•	•
1/2" NPT • 1/4"	A8-4 BN	•	•	•	1/2" NPT • 1/4"	A8-4 GFBN	•	•	•
1/2" NPT • 5/16"	A8-5 BN	•	•	•	1/2" NPT • 5/16"	A8-5 GFBN	•	•	•
1/2" NPT • 3/8"	A8-6 BN	•	•	•	1/2" NPT • 3/8"	A8-6 GFBN	•	•	•
1/2" NPT • 1/2"	A8-8 BN	•	•	•	1/2" NPT • 1/2"	A8-8 GFBN	•	•	•
1/2" NPT • 5/8"	A8-10 BN	•	•	•	1/2" NPT • 5/8"	A8-10 GFBN	•	•	•
1/2" NPT • 3/4"	A8-12 BN	•	•	•	1/2" NPT • 3/4"	A8-12 GFBN	•	•	•
3/4" NPT • 1/4"	A12-4 BN	•	•	•	3/4" NPT • 1/4"	A12-4 GFBN	•	•	•
3/4" NPT • 3/8"	A12-6 BN	•	•	•	3/4" NPT • 3/8"	A12-6 GFBN	•	•	•
3/4" NPT • 1/2"	A12-8 BN	•	•	•	3/4" NPT • 1/2"	A12-8 GFBN	•	•	•
3/4" NPT • 5/8"	A12-10 BN	•	•	•	3/4" NPT • 5/8"	A12-10 GFBN	•	•	•
3/4" NPT • 3/4"	A12-12 BN	•	•	•	3/4" NPT • 3/4"	A12-12 GFBN	•	•	•
3/4" NPT • 1"	A12-16 BN	•	•	•	3/4" NPT • 1"	A12-16 GFBN	•	•	•
1" NPT • 1"	A16-16 BN	•	•	•	1" NPT • 1"	A16-16 GFBN	•	•	•



Oetiker stainless steel worm drive and stepless ear clamps for automotive applications - see pages 132-133

Eldon James

Adapters-Miniature



Black Nylon • RoHS
Good Tensile Strength

10-32 UNF • 1/4-28 UNF • 1/16" NPT



Black Nylon

Thread - Barb	Part Number	.	.	.
10-32 UNF • 1/16"	A1032-1 BN	.	.	.
10-32 UNF • 3/32"	A1032-1.5 BN	.	.	.
10-32 UNF • 1/8"	A1032-2 BN	.	.	.
10-32 UNF • 5/32"	A1032-2.5 BN	.	.	.
10-32 Taper • 1/16"	A1032T-1 BN	.	.	.
10-32 Taper • 3/32"	A1032T-1.5 BN	.	.	.
10-32 Taper • 1/8"	A1032T-2 BN	.	.	.
10-32 Taper • 5/32"	A1032T-2.5 BN	.	.	.
1/4-28 UNF • 1/16"	A1428-1 BN	.	.	.
1/4-28 UNF • 3/32"	A1428-1.5 BN	.	.	.
1/4-28 UNF • 1/8"	A1428-2 BN	.	.	.
1/4-28 UNF • 5/32"	A1428-2.5 BN	.	.	.
1/4-28 UNF • 3/16"	A1428-3 BN	.	.	.
1/16" NPT • 1/16"	A1-1 BN	.	.	.
1/16" NPT • 3/32"	A1-1.5 BN	.	.	.
1/16" NPT • 1/8"	A1-2 BN	.	.	.
1/16" NPT • 5/32"	A1-2.5 BN	.	.	.
1/16" NPT • 3/16"	A1-3 BN	.	.	.

Adapters-Bulkhead

NPSM Straight Thread

Black Nylon • RoHS
Good Tensile Strength



Black Nylon

Barb-NPSM-Barb (1) (2)	Part Number	.	.	.
1/4" • 1/4"	BH4S4-4 BN	.	.	.
5/16" • 1/4"	BH4S5-4 BN	.	.	.
5/16" • 5/16"	BH4S5-5 BN	.	.	.
3/8" • 1/4"	BH4S6-4 BN	.	.	.
3/8" • 5/16"	BH4S6-5 BN	.	.	.
3/8" • 3/8"	BH4S6-6 BN	.	.	.

Call for additional barb options



Hex Nuts for Bulkhead Adapter Fittings
can be found on page 53



Adapters-Panel Mount



Black Nylon • RoHS
Good Tensile Strength

Straight Thread

■ Black Nylon

Straight Pipe Thread • Barb	Part Number	.	.	.
1/4" NPSM • 5/32"	PM4S-2.5 BN	.	.	.
1/4" NPSM • 3/16"	PM4S-3 BN	.	.	.
1/4" NPSM • 1/4"	PM4S-4 BN	.	.	.
1/4" NPSM • 5/16"	PM4S-5 BN	.	.	.
1/4" NPSM • 3/8"	PM4S-6 BN	.	.	.
1/4" NPSM • 1/2"	PM4S-8 BN	.	.	.

Bulkhead & Panel Mount Nuts



■ Black Nylon

Thread	Part Number	.	.	.
1/4" NPSF	G102-150-78	.	.	.



Couplers



Black Nylon • RoHS
Good Tensile Strength

Glass-Filled Black Nylon • RoHS
Excellent Tensile Strength and Impact Resistance

■ Black Nylon

■ Glass-Filled Black Nylon

Size	Part Number	.	.	.	Size	Part Number	.	.	.	Fits Metric Size Hose ID
1/16"	C0-1 BN	.	.	.	1/16"	C0-1 GFBN	.	.	.	1.59 mm
3/32"	C0-1.5 BN	.	.	.	3/32"	C0-1.5 GFBN	.	.	.	2.38 mm
1/8"	C0-2 BN	.	.	.	1/8"	C0-2 GFBN	.	.	.	3.18 mm
5/32"	C0-2.5 BN	.	.	.	5/32"	C0-2.5 GFBN	.	.	.	3.97 mm
3/16"	C0-3 BN	.	.	.	3/16"	C0-3 GFBN	.	.	.	4.76 mm
1/4"	C0-4 BN	.	.	.	1/4"	C0-4 GFBN	.	.	.	6.35 mm
5/16"	C0-5 BN	.	.	.	5/16"	C0-5 GFBN	.	.	.	7.94 mm
3/8"	C0-6 BN	.	.	.	3/8"	C0-6 GFBN	.	.	.	9.5 mm
1/2"	C0-8 BN	.	.	.	1/2"	C0-8 GFBN	.	.	.	12.7 mm
5/8"	C0-10 BN	.	.	.	5/8"	C0-10 GFBN	.	.	.	15.9 mm
3/4"	C0-12 BN	.	.	.	3/4"	C0-12 GFBN	.	.	.	19 mm
1"	C0-16 BN	.	.	.	1"	C0-16 GFBN	.	.	.	25.4 mm



Adapters-Panel Mount **BN** • Hex Nuts **BN** • Couplers **BN** Black Nylon **GFBN** Glass-Filled Black Nylon



Couplers-Reduction



ISO 9001
Quality System

Black Nylon • RoHS
Good Tensile Strength

Black Nylon

Size	Part Number	.	.	.	Fits Metric Size Hose ID
3/32" • 1/16"	C1.5-1 BN	.	.	.	2.38 mm • 1.59 mm
1/8" • 1/16"	C2-1 BN	.	.	.	3.18 mm • 1.59 mm
1/8" • 3/32"	C2-1.5 BN	.	.	.	3.18 mm • 2.38 mm
5/32" • 1/16"	C2.5-1 BN	.	.	.	3.97 mm • 1.59 mm
5/32" • 3/32"	C2.5-1.5 BN	.	.	.	3.97 mm • 2.38 mm
5/32" • 1/8"	C2.5-2 BN	.	.	.	3.97 mm • 3.18 mm
3/16" • 1/16"	C3-1 BN	.	.	.	4.76 mm • 1.59 mm
3/16" • 3/32"	C3-1.5 BN	.	.	.	4.76 mm • 2.38 mm
3/16" • 1/8"	C3-2 BN	.	.	.	4.76 mm • 3.18 mm
3/16" • 5/32"	C3-2.5 BN	.	.	.	4.76 mm • 3.97 mm
1/4" • 1/8"	C4-2 BN	.	.	.	6.35 mm • 3.18 mm
1/4" • 5/32"	C4-2.5 BN	.	.	.	6.35 mm • 3.97 mm
1/4" • 3/16"	C4-3 BN	.	.	.	6.35 mm • 4.76 mm
5/16" • 1/4"	C5-4 BN	.	.	.	7.94 mm • 6.35 mm
3/8" • 1/4"	C6-4 BN	.	.	.	9.5 mm • 6.35 mm
3/8" • 5/16"	C6-5 BN	.	.	.	9.5 mm • 7.94 mm
1/2" • 1/4"	C8-4 BN	.	.	.	12.7 mm • 6.35 mm
1/2" • 5/16"	C8-5 BN	.	.	.	12.7 mm • 7.94 mm
1/2" • 3/8"	C8-6 BN	.	.	.	12.7 mm • 9.5 mm
5/8" • 1/4"	C10-4 BN	.	.	.	15.9 mm • 6.35 mm
5/8" • 5/16"	C10-5 BN	.	.	.	15.9 mm • 7.94 mm
5/8" • 3/8"	C10-6 BN	.	.	.	15.9 mm • 9.5 mm
5/8" • 1/2"	C10-8 BN	.	.	.	15.9 mm • 12.7 mm
3/4" • 3/8"	C12-6 BN	.	.	.	19 mm • 9.5 mm
3/4" • 1/2"	C12-8 BN	.	.	.	19 mm • 12.7 mm
3/4" • 5/8"	C12-10 BN	.	.	.	19 mm • 15.9 mm
1" • 1/2"	C16-8 BN	.	.	.	25.4 mm • 12.7 mm
1" • 5/8"	C16-10 BN	.	.	.	25.4 mm • 15.9 mm
1" • 3/4"	C16-12 BN	.	.	.	25.4 mm • 19 mm

ISO 9001
Quality System

Black Nylon • RoHS
Good Tensile Strength

Crosses



Black Nylon

Size	Part Number	.	.	.	Fits Metric Size Hose ID
1/16"	X0-1 BN	.	.	.	1.59 mm
3/32"	X0-1.5 BN	.	.	.	2.38 mm
1/8"	X0-2 BN	.	.	.	3.18 mm
1/4"	X0-4 BN	.	.	.	6.35 mm



Reduction Couplers



ISO 9001
Quality System

Glass-Filled Black Nylon • RoHS
Excellent Tensile Strength and Impact
Resistance

Glass-Filled Black Nylon

Size	Part Number	.	.	.	Fits Metric Size Hose ID
5/32" • 1/8"	C2.5-2 GFBN	.	.	.	3.97 mm • 3.18 mm
3/16" • 1/8"	C3-2 GFBN	.	.	.	4.76 mm • 3.18 mm
1/4" • 1/8"	C4-2 GFBN	.	.	.	6.35 mm • 3.18 mm
1/4" • 5/32"	C4-2.5 GFBN	.	.	.	6.35 mm • 3.97 mm
1/4" • 3/16"	C4-3 GFBN	.	.	.	6.35 mm • 4.76 mm
5/16" • 1/4"	C5-4 GFBN	.	.	.	7.94 mm • 6.35 mm
3/8" • 1/4"	C6-4 GFBN	.	.	.	9.5 mm • 6.35 mm
3/8" • 5/16"	C6-5 GFBN	.	.	.	9.5 mm • 7.94 mm
1/2" • 1/4"	C8-4 GFBN	.	.	.	12.7 mm • 6.35 mm
1/2" • 5/16"	C8-5 GFBN	.	.	.	12.7 mm • 7.94 mm
1/2" • 3/8"	C8-6 GFBN	.	.	.	12.7 mm • 9.5 mm
5/8" • 1/4"	C10-4 GFBN	.	.	.	15.9 mm • 6.35 mm
5/8" • 5/16"	C10-5 GFBN	.	.	.	15.9 mm • 7.94 mm
5/8" • 3/8"	C10-6 GFBN	.	.	.	15.9 mm • 9.5 mm
5/8" • 1/2"	C10-8 GFBN	.	.	.	15.9 mm • 12.7 mm
3/4" • 3/8"	C12-6 GFBN	.	.	.	19 mm • 9.5 mm
3/4" • 1/2"	C12-8 GFBN	.	.	.	19 mm • 12.7 mm
3/4" • 5/8"	C12-10 GFBN	.	.	.	19 mm • 15.9 mm
1" • 1/2"	C16-8 GFBN	.	.	.	25.4 mm • 12.7 mm
1" • 5/8"	C16-10 GFBN	.	.	.	25.4 mm • 15.9 mm
1" • 3/4"	C16-12 GFBN	.	.	.	25.4 mm • 19 mm

ISO 9001
Quality System

Crosses



Glass-Filled Black Nylon

Size	Part Number	.	.	.	Fits Metric Size Hose ID
1/4"	X0-4 GFBN	.	.	.	6.35 mm



"Single Barb" Tee Fittings with
Oetiker Stepless Ear Clamp



Eldon James



Elbows-Equal

ISO 9001

Quality System

Black Nylon • RoHS
 Good Tensile Strength

Black Nylon

Size	Part Number	.	.	.	Fits Metric Size Hose ID
1/16"	L0-1 BN	.	.	.	1.59 mm
3/32"	L0-1.5 BN	.	.	.	2.38 mm
1/8"	L0-2 BN	.	.	.	3.18 mm
5/32"	L0-2.5 BN	.	.	.	3.97 mm
3/16"	L0-3 BN	.	.	.	4.76 mm
1/4"	L0-4 BN	.	.	.	6.35 mm
5/16"	L0-5 BN	.	.	.	7.94 mm
3/8"	L0-6 BN	.	.	.	9.5 mm
1/2"	L0-8 BN	.	.	.	12.7 mm
5/8"	L0-10 BN	.	.	.	15.9 mm
3/4"	L0-12 BN	.	.	.	19 mm
1"	L0-16 BN	.	.	.	25.4 mm



Elbows-Equal

Glass-Filled Black Nylon • RoHS
 Excellent Tensile Strength and Impact Resistance

Glass-Filled Black Nylon

Size	Part Number	.	.	.	Fits Metric Size Hose ID
5/32"	L0-2.5 GFBN	.	.	.	3.97 mm
3/16"	L0-3 GFBN	.	.	.	4.76 mm
1/4"	L0-4 GFBN	.	.	.	6.35 mm
5/16"	L0-5 GFBN	.	.	.	7.94 mm
3/8"	L0-6 GFBN	.	.	.	9.5 mm
1/2"	L0-8 GFBN	.	.	.	12.7 mm
5/8"	L0-10 GFBN	.	.	.	15.9 mm
3/4"	L0-12 GFBN	.	.	.	19 mm
1"	L0-16 GFBN	.	.	.	25.4 mm



Black Nylon Utility Kits

 Adapters • Threaded Elbows & Tees • British Pipe Threads
 • Couplers and Reducers • Barbed Elbows & Tees,
 and more.....See page 138 for details.

Eldon James

Elbows-Reduction



Black Nylon • RoHS
Good Tensile Strength

Black Nylon

Size	Part Number	.	.	.
3/32" • 1/16"	RL1.5-1 BN	.	.	.
1/8" • 1/16"	RL2-1 BN	.	.	.
1/8" • 3/32"	RL2-1.5 BN	.	.	.
5/16" • 1/4"	RL5-4 BN	.	.	.
3/8" • 1/4"	RL6-4 BN	.	.	.
1/2" • 3/8"	RL8-6 BN	.	.	.

Fits Metric Size Hose ID
2.38 mm • 1.59 mm
3.18 mm • 1.59 mm
3.18 mm • 2.38 mm
7.94 mm • 6.35 mm
9.5 mm • 6.35 mm
12.7 mm • 9.5 mm



Elbows-Reduction



Glass-Filled Black Nylon • RoHS
Excellent Tensile Strength and Impact Resistance

Glass-Filled Black Nylon

Size	Part Number	.	.	.
5/16" • 1/4"	RL5-4 GFBN	.	.	.
3/8" • 1/4"	RL6-4 GFBN	.	.	.
1/2" • 3/8"	RL8-6 GFBN	.	.	.

Fits Metric Size Hose ID
7.94 mm • 6.35 mm
9.5 mm • 6.35 mm
12.7 mm • 9.5 mm



Elbows-Threaded Miniature

Black Nylon • RoHS
Good Tensile Strength

Black Nylon

10-32 UNF • 1/4-28 UNF • 1/16" NPT

Thread - Barb	Part Number	.	.	.
10-32 UNF • 1/16"	L1032-1 BN	.	.	.
10-32 UNF • 3/32"	L1032-1.5 BN	.	.	.
10-32 UNF • 1/8"	L1032-2 BN	.	.	.
10-32 Taper • 1/16"	L1032T-1 BN	.	.	.
10-32 Taper • 3/32"	L1032T-1.5 BN	.	.	.
10-32 Taper • 1/8"	L1032T-2 BN	.	.	.
1/16" NPT • 1/16"	L1-1 BN	.	.	.
1/16" NPT • 3/32"	L1-1.5 BN	.	.	.
1/16" NPT • 1/8"	L1-2 BN	.	.	.
1/16" NPT • 5/32"	L1-2.5 BN	.	.	.
1/16" NPT • 3/16"	L1-3 BN	.	.	.





Elbows-Threaded

NPT 1/8" to 1"

ISO 9001
Quality System

Black Nylon • RoHS
Good Tensile Strength

Glass-Filled Black Nylon • RoHS
Excellent Impact Resistance

Black Nylon

Glass-Filled Black Nylon

Thread - Barb	Part Number	•	•	•	Thread - Barb	Part Number	•	•	•
1/8" NPT • 1/16"	L2-1 BN	•	•	•	1/8" NPT • 1/16"	L2-1 GFBN	—	—	—
1/8" NPT • 3/32"	L2-1.5 BN	•	•	•	1/8" NPT • 3/32"	L2-1.5 GFBN	—	—	—
1/8" NPT • 1/8"	L2-2 BN	•	•	•	1/8" NPT • 1/8"	L2-2 GFBN	•	•	•
1/8" NPT • 5/32"	L2-2.5 BN	•	•	•	1/8" NPT • 5/32"	L2-2.5 GFBN	•	•	•
1/8" NPT • 3/16"	L2-3 BN	•	•	•	1/8" NPT • 3/16"	L2-3 GFBN	•	•	•
1/8" NPT • 1/4"	L2-4 BN	•	•	•	1/8" NPT • 1/4"	L2-4 GFBN	•	•	•
1/8" NPT • 5/16"	L2-5 BN	•	•	•	1/8" NPT • 5/16"	L2-5 GFBN	•	•	•
1/8" NPT • 3/8"	L2-6 BN	•	•	•	1/8" NPT • 3/8"	L2-6 GFBN	•	•	•
1/4" NPT • 1/8"	L4-2 BN	•	•	•	1/4" NPT • 1/8"	L4-2 GFBN	•	•	•
1/4" NPT • 5/32"	L4-2.5 BN	•	•	•	1/4" NPT • 5/32"	L4-2.5 GFBN	•	•	•
1/4" NPT • 3/16"	L4-3 BN	•	•	•	1/4" NPT • 3/16"	L4-3 GFBN	•	•	•
1/4" NPT • 1/4"	L4-4 BN	•	•	•	1/4" NPT • 1/4"	L4-4 GFBN	•	•	•
1/4" NPT • 5/16"	L4-5 BN	•	•	•	1/4" NPT • 5/16"	L4-5 GFBN	•	•	•
1/4" NPT • 3/8"	L4-6 BN	•	•	•	1/4" NPT • 3/8"	L4-6 GFBN	•	•	•
1/4" NPT • 1/2"	L4-8 BN	•	•	•	1/4" NPT • 1/2"	L4-8 GFBN	•	•	•
3/8" NPT • 1/4"	L6-4 BN	•	•	•	3/8" NPT • 1/4"	L6-4 GFBN	•	•	•
3/8" NPT • 5/16"	L6-5 BN	•	•	•	3/8" NPT • 5/16"	L6-5 GFBN	•	•	•
3/8" NPT • 3/8"	L6-6 BN	•	•	•	3/8" NPT • 3/8"	L6-6 GFBN	•	•	•
3/8" NPT • 1/2"	L6-8 BN	•	•	•	3/8" NPT • 1/2"	L6-8 GFBN	•	•	•
1/2" NPT • 1/4"	L8-4 BN	•	•	•	1/2" NPT • 1/4"	L8-4 GFBN	•	•	•
1/2" NPT • 3/8"	L8-6 BN	•	•	•	1/2" NPT • 3/8"	L8-6 GFBN	•	•	•
1/2" NPT • 1/2"	L8-8 BN	•	•	•	1/2" NPT • 1/2"	L8-8 GFBN	•	•	•
1/2" NPT • 5/8"	L8-10 BN	•	•	•	1/2" NPT • 5/8"	L8-10 GFBN	•	•	•
1/2" NPT • 3/4"	L8-12 BN	•	•	•	1/2" NPT • 3/4"	L8-12 GFBN	•	•	•
3/4" NPT • 1/4"	L12-4 BN	•	•	•	3/4" NPT • 1/4"	L12-4 GFBN	•	•	•
3/4" NPT • 3/8"	L12-6 BN	•	•	•	3/4" NPT • 3/8"	L12-6 GFBN	•	•	•
3/4" NPT • 1/2"	L12-8 BN	•	•	•	3/4" NPT • 1/2"	L12-8 GFBN	•	•	•
3/4" NPT • 5/8"	L12-10 BN	•	•	•	3/4" NPT • 5/8"	L12-10 GFBN	•	•	•
3/4" NPT • 3/4"	L12-12 BN	•	•	•	3/4" NPT • 3/4"	L12-12 GFBN	•	•	•
3/4" NPT • 1"	L12-16 BN	•	•	•	3/4" NPT • 1"	L12-16 GFBN	•	•	•
1" NPT • 3/4"	L16-12 BN	•	•	•	1" NPT • 3/4"	L16-12 GFBN	•	•	•
1" NPT • 1"	L16-16 BN	•	•	•	1" NPT • 1"	L16-16 GFBN	•	•	•



Garden Hose Connectors



ISO 9001
Quality System

Black Nylon • RoHS
Good Tensile Strength

Black Nylon

3/4" GH Thread • Barb	Part Number	.	.	.
3/4" GH • 1/4"	A12GH-4 BN	.	.	.
3/4" GH • 3/8"	A12GH-6 BN	.	.	.
3/4" GH • 1/2"	A12GH-8 BN	.	.	.
3/4" GH • 5/8"	A12GH-10 BN	.	.	.
3/4" GH • 3/4"	A12GH-12 BN	.	.	.
3/4" GH • 1"	A12GH-16 BN	.	.	.



Nipples



Black Nylon • RoHS
Good Tensile Strength

Glass-Filled Black Nylon • RoHS
Excellent Impact Resistance

Black Nylon

Glass-Filled Black Nylon

Size	Part Number	.	.	.	Size	Part Number	.	.	.
1/8" NPT	N2 BN	.	.	.	1/8" NPT	N2 GFBN	.	.	.
1/4" NPT	N4 BN	.	.	.	1/4" NPT	N4 GFBN	.	.	.
3/8" NPT	N6 BN	.	.	.	3/8" NPT	N6 GFBN	.	.	.
1/2" NPT	N8 BN	.	.	.	1/2" NPT	N8 GFBN	.	.	.
3/4" NPT	N12 BN	.	.	.	3/4" NPT	N12 GFBN	.	.	.
1" NPT	N16 BN	.	.	.	1" NPT	N16 GFBN	.	.	.



Nipples-Reduction



Black Nylon • RoHS
Good Tensile Strength

Glass-Filled Black Nylon • RoHS
Excellent Impact Resistance

Black Nylon

Glass-Filled Black Nylon

NPT • NPT	Part Number	.	.	.	NPT • NPT	Part Number	.	.	.
1/4" • 1/8"	RN4-2 BN	.	.	.	1/4" • 1/8"	RN4-2 GFBN	.	.	.
3/8" • 1/8"	RN6-2 BN	.	.	.	3/8" • 1/8"	RN6-2 GFBN	.	.	.
3/8" • 1/4"	RN6-4 BN	.	.	.	3/8" • 1/4"	RN6-4 GFBN	.	.	.
1/2" • 1/8"	RN8-2 BN	.	.	.	1/2" • 1/8"	RN8-2 GFBN	.	.	.
1/2" • 1/4"	RN8-4 BN	.	.	.	1/2" • 1/4"	RN8-4 GFBN	.	.	.
1/2" • 3/8"	RN8-6 BN	.	.	.	1/2" • 3/8"	RN8-6 GFBN	.	.	.
1" • 3/4"	RN16-12 BN	.	.	.	1" • 3/4"	RN16-12 GFBN	.	.	.



Plug-Flanged



Flanged Plug

Straight Thread

Black Nylon

Thread	Part Number	.	.	.
1/4" NPSM	PMP4S BN	.	.	.

Plugs-Insert



Black Nylon • RoHS
Good Tensile Strength

Black Nylon

Size	Part Number	.	.	.	Fits Metric Size Hose ID
1/16"	P0-1 BN	.	.	.	1.59 mm
3/32"	P0-1.5 BN	.	.	.	2.38 mm
1/8"	P0-2 BN	.	.	.	3.18 mm
5/32"	P0-2.5 BN	.	.	.	3.97 mm
3/16"	P0-3 BN	.	.	.	4.76 mm
1/4"	P0-4 BN	.	.	.	6.35 mm
3/8"	P0-6 BN	.	.	.	9.5 mm
1/2"	P0-8 BN	.	.	.	12.7 mm

Plugs-Threaded Hex



Black Nylon • RoHS
Good Tensile Strength

Glass-Filled Black Nylon • RoHS
Excellent Impact Resistance

Black Nylon

Glass-Filled Black Nylon

Size	Part Number	.	.	.	Size	Part Number	.	.	.
10-32 UNF	P1032 BN	.	.	.	10-32 UNF	P1032 GFBN	.	.	.
10-32 Taper	P1032T BN	.	.	.	10-32 Taper	P1032T GFBN	.	.	.
1/4-28 UNF	P1428 BN	.	.	.	1/4-28 UNF	P1428 GFBN	.	.	.
1/16" NPT	P1 BN	.	.	.	1/16" NPT	P1 GFBN	.	.	.
1/8" NPT	P2 BN	.	.	.	1/8" NPT	P2 GFBN	.	.	.
1/4" NPT	P4 BN	.	.	.	1/4" NPT	P4 GFBN	.	.	.
3/8" NPT	P6 BN	.	.	.	3/8" NPT	P6 GFBN	.	.	.
1/2" NPT	P8 BN	.	.	.	1/2" NPT	P8 GFBN	.	.	.
3/4" NPT	P12 BN	.	.	.	3/4" NPT	P12 GFBN	.	.	.
1" NPT	P16 BN	.	.	.	1" NPT	P16 GFBN	.	.	.



Tees-Equal Barbed

ISO 9001
Quality System

Black Nylon • RoHS
Good Tensile Strength

Black Nylon

Size	Part Number	•	•	•	Fits Metric Size Hose ID
1/16"	T0-1 BN	•	•	•	1.59 mm
3/32"	T0-1.5 BN	•	•	•	2.38 mm
1/8"	T0-2 BN	•	•	•	3.18 mm
5/32"	T0-2.5 BN	•	•	•	3.97 mm
3/16"	T0-3 BN	•	•	•	4.76 mm
1/4"	T0-4 BN	•	•	•	6.35 mm
5/16"	T0-5 BN	•	•	•	7.94 mm
3/8"	T0-6 BN	•	•	•	9.5 mm
1/2"	T0-8 BN	•	•	•	12.7 mm
5/8"	T0-10 BN	•	•	•	15.9 mm
3/4"	T0-12 BN	•	•	•	19 mm
1"	T0-16 BN	•	•	•	25.4 mm



Tees-Equal Barbed

Glass-Filled Black Nylon • RoHS
Excellent Tensile Strength and Impact Resistance

Glass-Filled Black Nylon

Size	Part Number	•	•	•	Fits Metric Size Hose ID
5/32"	T0-2.5 GFBN	•	•	•	3.97 mm
3/16"	T0-3 GFBN	•	•	•	4.76 mm
1/4"	T0-4 GFBN	•	•	•	6.35 mm
5/16"	T0-5 GFBN	•	•	•	7.94 mm
3/8"	T0-6 GFBN	•	•	•	9.5 mm
1/2"	T0-8 GFBN	•	•	•	12.7 mm
5/8"	T0-10 GFBN	•	•	•	15.9 mm
3/4"	T0-12 GFBN	•	•	•	19 mm
1"	T0-16 GFBN	•	•	•	25.4 mm

Black Nylon Fittings

- Highest quality, impact resistant nylon - a more expensive formulation that is not generally specified by other manufacturers
- RoHS Compliant - EU Directive 2002/95/EC
- Manufactured from materials approved by major automotive manufacturers
- Temperature range -50°F to 275°F (-46°C to 135°C)

Eldon James

ISO 9001
Quality System

Tees-Reduction

Black Nylon • RoHS
Good Tensile Strength



Black Nylon

Body(2)-Leg(1)	Part Number	.	.	.
1/16" • 3/32"	RT1-1.5 BN	.	.	.
1/16" • 1/8"	RT1-2 BN	.	.	.
3/32" • 1/16"	RT1.5-1 BN	.	.	.
3/32" • 1/8"	RT1.5-2 BN	.	.	.
1/8" • 1/16"	RT2-1 BN	.	.	.
1/8" • 3/32"	RT2-1.5 BN	.	.	.
5/32" • 3/8"	RT2.5-6 BN	.	.	.
1/4" • 3/32"	RT4-1.5 BN	.	.	.
1/4" • 1/8"	RT4-2 BN	.	.	.
1/4" • 3/16"	RT4-3 BN	.	.	.
1/4" • 3/8"	RT4-6 BN	.	.	.
1/4" • 5/8"	RT4-10 BN	.	.	.
3/8" • 1/4"	RT6-4 BN	.	.	.
1/2" • 3/8"	RT8-6 BN	.	.	.
5/8" • 3/8"	RT10-6 BN	.	.	.
3/4" • 3/8"	RT12-6 BN	.	.	.
3/4" • 1/2"	RT12-8 BN	.	.	.
1" • 5/8"	RT16-10 BN	.	.	.

Fits Metric Size
Hose ID

1.59 mm • 2.38 mm
1.59 mm • 3.18 mm
2.38 mm • 1.59 mm
2.38 mm • 3.18 mm
3.18 mm • 1.59 mm
3.18 mm • 2.38 mm
3.97 mm • 9.5 mm
6.35 mm • 2.38 mm
6.35 mm • 3.18 mm
6.35 mm • 4.76 mm
6.35 mm • 9.5 mm
6.35 mm • 15.9 mm
9.5 mm • 6.35 mm
12.7 mm • 9.5 mm
15.9 mm • 9.5 mm
19 mm • 9.5 mm
19 mm • 12.7 mm
25.4 mm • 15.9 mm

Tees-Reduction

Glass-Filled Black Nylon • RoHS
Excellent Impact Resistance



Glass-Filled Black Nylon

Body(2)-Leg(1)	Part Number	.	.	.
5/32" • 3/8"	RT2.5-6 GFBN	.	.	.
1/4" • 3/8"	RT4-6 GFBN	.	.	.
1/4" • 5/8"	RT4-10 GFBN	.	.	.
1/2" • 3/8"	RT8-6 GFBN	.	.	.
5/8" • 3/8"	RT10-6 GFBN	.	.	.
3/4" • 3/8"	RT12-6 GFBN	.	.	.
3/4" • 1/2"	RT12-8 GFBN	.	.	.
1" • 5/8"	RT16-10 GFBN	.	.	.

Fits Metric Size
Hose ID

3.97 mm • 9.5 mm
6.35 mm • 9.5 mm
6.35 mm • 15.9 mm
12.7 mm • 9.5 mm
15.9 mm • 9.5 mm
19 mm • 9.5 mm
19 mm • 12.7 mm
25.4 mm • 15.9 mm

Tees-Asymmetric Reduction

Black Nylon • RoHS
Good Tensile Strength



Black Nylon

(2) Size (1)	Part Number	.	.	.
3/32" • 1/16"	LRT1.5-1 BN	.	.	.
1/8" • 1/16"	LRT2-1 BN	.	.	.
1/8" • 3/32"	LRT2-1.5 BN	.	.	.



Black Nylon • RoHS
Good Tensile Strength

Tees-Threaded

NPT 1/8" to 1"

Glass-Filled Black Nylon • RoHS
Excellent Impact Resistance

Black Nylon

Glass-Filled Black Nylon

Thread - Barb	Part Number	•	•	•	Thread - Barb	Part Number	•	•	•
1/8" NPT • 1/16"	T2-1 BN	•	•	•	1/8" NPT • 1/16"	T2-1 GFBN	–	–	–
1/8" NPT • 3/32"	T2-1.5 BN	•	•	•	1/8" NPT • 3/32"	T2-1.5 GFBN	–	–	–
1/8" NPT • 1/8"	T2-2 BN	•	•	•	1/8" NPT • 1/8"	T2-2 GFBN	–	–	–
1/8" NPT • 5/32"	T2-2.5 BN	•	•	•	1/8" NPT • 5/32"	T2-2.5 GFBN	•	•	•
1/8" NPT • 3/16"	T2-3 BN	•	•	•	1/8" NPT • 3/16"	T2-3 GFBN	•	•	•
1/8" NPT • 1/4"	T2-4 BN	•	•	•	1/8" NPT • 1/4"	T2-4 GFBN	•	•	•
1/8" NPT • 3/8"	T2-6 BN	•	•	•	1/8" NPT • 3/8"	T2-6 GFBN	•	•	•
1/4" NPT • 5/32"	T4-2.5 BN	•	•	•	1/4" NPT • 5/32"	T4-2.5 GFBN	•	•	•
1/4" NPT • 3/16"	T4-3 BN	•	•	•	1/4" NPT • 3/16"	T4-3 GFBN	•	•	•
1/4" NPT • 1/4"	T4-4 BN	•	•	•	1/4" NPT • 1/4"	T4-4 GFBN	•	•	•
1/4" NPT • 5/16"	T4-5 BN	•	•	•	1/4" NPT • 5/16"	T4-5 GFBN	•	•	•
1/4" NPT • 3/8"	T4-6 BN	•	•	•	1/4" NPT • 3/8"	T4-6 GFBN	•	•	•
1/4" NPT • 1/2"	T4-8 BN	•	•	•	1/4" NPT • 1/2"	T4-8 GFBN	•	•	•
3/8" NPT • 1/4"	T6-4 BN	•	•	•	3/8" NPT • 1/4"	T6-4 GFBN	•	•	•
3/8" NPT • 5/16"	T6-5 BN	•	•	•	3/8" NPT • 5/16"	T6-5 GFBN	•	•	•
3/8" NPT • 3/8"	T6-6 BN	•	•	•	3/8" NPT • 3/8"	T6-6 GFBN	•	•	•
3/8" NPT • 1/2"	T6-8 BN	•	•	•	3/8" NPT • 1/2"	T6-8 GFBN	•	•	•
1/2" NPT • 1/4"	T8-4 BN	•	•	•	1/2" NPT • 1/4"	T8-4 GFBN	•	•	•
1/2" NPT • 3/8"	T8-6 BN	•	•	•	1/2" NPT • 3/8"	T8-6 GFBN	•	•	•
1/2" NPT • 1/2"	T8-8 BN	•	•	•	1/2" NPT • 1/2"	T8-8 GFBN	•	•	•
1/2" NPT • 5/8"	T8-10 BN	•	•	•	1/2" NPT • 5/8"	T8-10 GFBN	•	•	•
1/2" NPT • 3/4"	T8-12 BN	•	•	•	1/2" NPT • 3/4"	T8-12 GFBN	•	•	•
3/4" NPT • 1/4"	T12-4 BN	•	•	•	3/4" NPT • 1/4"	T12-4 GFBN	•	•	•
3/4" NPT • 3/8"	T12-6 BN	•	•	•	3/4" NPT • 3/8"	T12-6 GFBN	•	•	•
3/4" NPT • 1/2"	T12-8 BN	•	•	•	3/4" NPT • 1/2"	T12-8 GFBN	•	•	•
3/4" NPT • 5/8"	T12-10 BN	•	•	•	3/4" NPT • 5/8"	T12-10 GFBN	•	•	•
3/4" NPT • 3/4"	T12-12 BN	•	•	•	3/4" NPT • 3/4"	T12-12 GFBN	•	•	•
3/4" NPT • 1"	T12-16 BN	•	•	•	3/4" NPT • 1"	T12-16 GFBN	•	•	•
1" NPT • 3/4"	T16-12 BN	•	•	•	1" NPT • 3/4"	T16-12 GFBN	•	•	•
1" NPT • 1"	T16-16 BN	•	•	•	1" NPT • 1"	T16-16 GFBN	•	•	•

■ Glass-Filled Black Nylon Fittings

- RoHS Compliant - EU Directive 2002/95/EC
- Heat deflection Temp. ASTM D64: 475°F (246°C) @ 264 psi
- Manufactured from materials approved and specified by major automotive manufacturers
- Hose-stops on barb shafts provide a gauge for optimum insertion depth into the hose
- 30% Glass fiber reinforcement significantly increases impact resistance



Tees-Threaded Miniature



Black Nylon • RoHS
Good Tensile Strength

Black Nylon

Thread - Barb	Part Number	•	•	•
10-32 UNF • 1/16"	T1032-1 BN	•	•	•
10-32 UNF • 3/32"	T1032-1.5 BN	•	•	•
10-32 UNF • 1/8"	T1032-2 BN	•	•	•
10-32 UNF • 5/32"	T1032-2.5 BN	•	•	•
10-32 Taper • 1/16"	T1032T-1 BN	•	•	•
10-32 Taper • 3/32"	T1032T-1.5 BN	•	•	•
10-32 Taper • 1/8"	T1032T-2 BN	•	•	•
10-32 Taper • 5/32"	T1032T-2.5 BN	•	•	•
1/16" NPT • 1/16"	T1-1 BN	•	•	•
1/16" NPT • 3/32"	T1-1.5 BN	•	•	•
1/16" NPT • 1/8"	T1-2 BN	•	•	•
1/16" NPT • 5/32"	T1-2.5 BN	•	•	•
1/16" NPT • 3/16"	T1-3 BN	•	•	•

Y-Connectors



Black Nylon • RoHS
Good Tensile Strength



Black Nylon

Size	Part Number	•	•	•	Fits Metric Size Hose ID
1/16"	Y0-1 BN	•	•	•	1.59 mm
3/32"	Y0-1.5 BN	•	•	•	2.38 mm
1/8"	Y0-2 BN	•	•	•	3.18 mm
3/16"	Y0-3 BN	•	•	•	4.76 mm
1/4"	Y0-4 BN	•	•	•	6.35 mm
3/8"	Y0-6 BN	•	•	•	9.5 mm
1/2"	Y0-8 BN	•	•	•	12.7 mm
5/8"	Y0-10 BN	•	•	•	15.9 mm

Y-Connectors



Glass-Filled Black Nylon • RoHS
Excellent Impact Resistance



Glass-Filled Black Nylon

Size	Part Number	•	•	•	Fits Metric Size Hose ID
1/8"	Y0-2 GFBN	•	•	•	3.18 mm
3/16"	Y0-3 GFBN	•	•	•	4.76 mm
1/4"	Y0-4 GFBN	•	•	•	6.35 mm
3/8"	Y0-6 GFBN	•	•	•	9.5 mm
1/2"	Y0-8 GFBN	•	•	•	12.7 mm
5/8"	Y0-10 GFBN	•	•	•	15.9 mm



Adapters-BSPT



British Standard Pipe Threads



Black Nylon • RoHS
Good Tensile Strength

Glass-Filled Black Nylon • RoHS
Excellent Impact Resistance

Black Nylon

Glass-Filled Black Nylon

Thread - Barb	Part Number	•	•	•	Thread - Barb	Part Number	•	•	•
1/8" BSPT • 1/8"	A2B-2 BN	•	•	•	1/8" BSPT • 1/8"	A2B-2 GFBN	•	•	•
1/8" BSPT • 5/32"	A2B-2.5 BN	•	•	•	1/8" BSPT • 5/32"	A2B-2.5 GFBN	•	•	•
1/8" BSPT • 1/4"	A2B-4 BN	•	•	•	1/8" BSPT • 1/4"	A2B-4 GFBN	•	•	•
1/8" BSPT • 5/16"	A2B-5 BN	•	•	•	1/8" BSPT • 5/16"	A2B-5 GFBN	•	•	•
1/8" BSPT • 3/8"	A2B-6 BN	•	•	•	1/8" BSPT • 3/8"	A2B-6 GFBN	•	•	•
1/4" BSPT • 1/8"	A4B-2 BN	•	•	•	1/4" BSPT • 1/8"	A4B-2 GFBN	•	•	•
1/4" BSPT • 5/32"	A4B-2.5 BN	•	•	•	1/4" BSPT • 5/32"	A4B-2.5 GFBN	•	•	•
1/4" BSPT • 3/16"	A4B-3 BN	•	•	•	1/4" BSPT • 3/16"	A4B-3 GFBN	•	•	•
1/4" BSPT • 1/4"	A4B-4 BN	•	•	•	1/4" BSPT • 1/4"	A4B-4 GFBN	•	•	•
1/4" BSPT • 5/16"	A4B-5 BN	•	•	•	1/4" BSPT • 5/16"	A4B-5 GFBN	•	•	•
1/4" BSPT • 3/8"	A4B-6 BN	•	•	•	1/4" BSPT • 3/8"	A4B-6 GFBN	•	•	•
1/4" BSPT • 1/2"	A4B-8 BN	•	•	•	1/4" BSPT • 1/2"	A4B-8 GFBN	•	•	•
3/8" BSPT • 1/4"	A6B-4 BN	•	•	•	3/8" BSPT • 1/4"	A6B-4 GFBN	•	•	•
3/8" BSPT • 5/16"	A6B-5 BN	•	•	•	3/8" BSPT • 5/16"	A6B-5 GFBN	•	•	•
3/8" BSPT • 3/8"	A6B-6 BN	•	•	•	3/8" BSPT • 3/8"	A6B-6 GFBN	•	•	•
3/8" BSPT • 1/2"	A6B-8 BN	•	•	•	3/8" BSPT • 1/2"	A6B-8 GFBN	•	•	•

Elbows-BSPT



British Standard Pipe Threads



Black Nylon • RoHS
Good Tensile Strength

Glass-Filled Black Nylon • RoHS
Excellent Impact Resistance

Black Nylon

Glass-Filled Black Nylon

Thread - Barb	Part Number	•	•	•	Thread - Barb	Part Number	•	•	•
1/8" BSPT • 1/8"	L2B-2 BN	•	•	•	1/8" BSPT • 1/8"	L2B-2 GFBN	•	•	•
1/8" BSPT • 5/32"	L2B-2.5 BN	•	•	•	1/8" BSPT • 5/32"	L2B-2.5 GFBN	•	•	•
1/8" BSPT • 1/4"	L2B-4 BN	•	•	•	1/8" BSPT • 1/4"	L2B-4 GFBN	•	•	•
1/8" BSPT • 5/16"	L2B-5 BN	•	•	•	1/8" BSPT • 5/16"	L2B-5 GFBN	•	•	•
1/8" BSPT • 3/8"	L2B-6 BN	•	•	•	1/8" BSPT • 3/8"	L2B-6 GFBN	•	•	•
1/4" BSPT • 1/8"	L4B-2 BN	•	•	•	1/4" BSPT • 1/8"	L4B-2 GFBN	•	•	•
1/4" BSPT • 5/32"	L4B-2.5 BN	•	•	•	1/4" BSPT • 5/32"	L4B-2.5 GFBN	•	•	•
1/4" BSPT • 3/16"	L4B-3 BN	•	•	•	1/4" BSPT • 3/16"	L4B-3 GFBN	•	•	•
1/4" BSPT • 1/4"	L4B-4 BN	•	•	•	1/4" BSPT • 1/4"	L4B-4 GFBN	•	•	•
1/4" BSPT • 5/16"	L4B-5 BN	•	•	•	1/4" BSPT • 5/16"	L4B-5 GFBN	•	•	•
1/4" BSPT • 3/8"	L4B-6 BN	•	•	•	1/4" BSPT • 3/8"	L4B-6 GFBN	•	•	•
1/4" BSPT • 1/2"	L4B-8 BN	•	•	•	1/4" BSPT • 1/2"	L4B-8 GFBN	•	•	•
3/8" BSPT • 1/4"	L6B-4 BN	•	•	•	3/8" BSPT • 1/4"	L6B-4 GFBN	•	•	•
3/8" BSPT • 5/16"	L6B-5 BN	•	•	•	3/8" BSPT • 5/16"	L6B-5 GFBN	•	•	•
3/8" BSPT • 3/8"	L6B-6 BN	•	•	•	3/8" BSPT • 3/8"	L6B-6 GFBN	•	•	•
3/8" BSPT • 1/2"	L6B-8 BN	•	•	•	3/8" BSPT • 1/2"	L6B-8 GFBN	•	•	•



Plugs-BSPT

British Standard Pipe Threads



Black Nylon • RoHS
Good Tensile Strength

<u>Black Nylon</u>					<u>Glass-Filled Black Nylon</u>				
Size	Part Number	•	•	•	Size	Part Number	•	•	•
1/8" BSPT	P2B BN	•	•	•	1/8" BSPT	P2B GFBN	•	•	•
1/4" BSPT	P4B BN	•	•	•	1/4" BSPT	P4B GFBN	•	•	•
3/8" BSPT	P6B BN	•	•	•	3/8" BSPT	P6B GFBN	•	•	•



Tees-BSPT

British Standard Pipe Threads

Glass-Filled Black Nylon • RoHS
Excellent Impact Resistance

<u>Black Nylon</u>					<u>Glass-Filled Black Nylon</u>				
Thread - Barb	Part Number	•	•	•	Thread - Barb	Part Number	•	•	•
1/8" BSPT • 5/32"	T2B-2.5 BN	•	•	•	1/8" BSPT • 5/32"	T2B-2.5 GFBN	•	•	•
1/8" BSPT • 1/4"	T2B-4 BN	•	•	•	1/8" BSPT • 1/4"	T2B-4 GFBN	•	•	•
1/8" BSPT • 3/8"	T2B-6 BN	•	•	•	1/8" BSPT • 3/8"	T2B-6 GFBN	•	•	•
1/4" BSPT • 5/32"	T4B-2.5 BN	•	•	•	1/4" BSPT • 5/32"	T4B-2.5 GFBN	•	•	•
1/4" BSPT • 3/16"	T4B-3 BN	•	•	•	1/4" BSPT • 3/16"	T4B-3 GFBN	•	•	•
1/4" BSPT • 1/4"	T4B-4 BN	•	•	•	1/4" BSPT • 1/4"	T4B-4 GFBN	•	•	•
1/4" BSPT • 5/16"	T4B-5 BN	•	•	•	1/4" BSPT • 5/16"	T4B-5 GFBN	•	•	•
1/4" BSPT • 3/8"	T4B-6 BN	•	•	•	1/4" BSPT • 3/8"	T4B-6 GFBN	•	•	•
1/4" BSPT • 1/2"	T4B-8 BN	•	•	•	1/4" BSPT • 1/2"	T4B-8 GFBN	•	•	•
3/8" BSPT • 1/4"	T6B-4 BN	•	•	•	3/8" BSPT • 1/4"	T6B-4 GFBN	•	•	•
3/8" BSPT • 5/16"	T6B-5 BN	•	•	•	3/8" BSPT • 5/16"	T6B-5 GFBN	•	•	•
3/8" BSPT • 3/8"	T6B-6 BN	•	•	•	3/8" BSPT • 3/8"	T6B-6 GFBN	•	•	•
3/8" BSPT • 1/2"	T6B-8 BN	•	•	•	3/8" BSPT • 1/2"	T6B-8 GFBN	•	•	•

- Fuel resistant tubing for automotive applications
- General purpose Flexelene™ polyethylene tubing
- Braid-reinforced PVC tubing
- Clear PVC tubing: Pages 128-130
- Stainless steel clamps and accessories: Pages 132-133

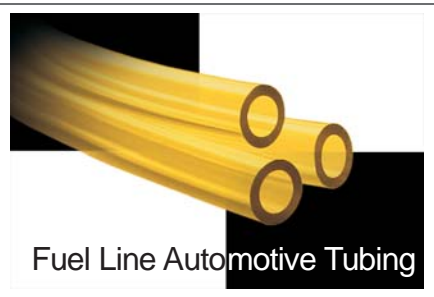

Eldon James

Industrial Materials Fittings: See pages 68-94
 Gray Kynar® • White Polypropylene • White Nylon • Black Nylon

Thread Torque: The general rule for plastic threads is; finger-tight plus 1/2 to 1 turn with a wrench.

*Over-tightened plastic threads can stress the fitting and may cause it to fail.

Typical EJ Nominal Barb Dimensions - Plastic Hose Barbs

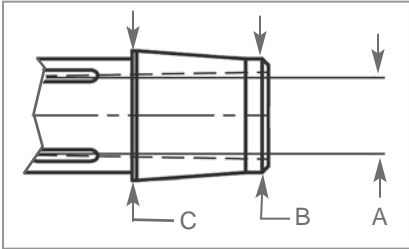

For stainless steel barb dimensions see page 43.

Barb Size	Fits Hose ID	Dim. A	Dim. B	Dim. C
1	1/16"	.048"	.070"	.098"
1.5	3/32"	.068"	.100"	.135"
2	1/8"	.075"	.125"	.161"
2.5	5/32"	.117"	.160"	.207"
3	3/16"	.115"	.180"	.244"
4	1/4"	.140"	.250"	.300"
5	5/16"	.200"	.313"	.364"
6	3/8"	.250"	.375"	.450"
8	1/2"	.368"	.500"	.570"
10	5/8"	.470"	.625"	.712"
12	3/4"	.580"	.750"	.855"
16	1"	.800"	1.00"	1.100"

Metric Equivalent Hose ID

EJ Barb #	Hose Size ID in.	Fits Metric Size Hose ID	EJ Barb #	Hose Size ID in.	Fits Metric Size Hose ID
1	1/16"	1.59 mm	5	5/16"	7.94 mm
1.5	3/32"	2.38 mm	6	3/8"	9.5 mm
2	1/8"	3.18 mm	8	1/2"	12.7 mm
2.5	5/32"	3.97 mm	10	5/8"	15.9 mm
3	3/16"	4.76 mm	12	3/4"	19 mm
4	1/4"	6.35 mm	16	1"	25.4 mm

Eldon James uses Natural Kynar®, Natural Nylon, and Natural High Density Polyethylene materials that have been certified as safe for contact with food and water. In addition, Eldon James has received NSF/ANSI Standard 51 & 61 certifications for a wide range of its fittings sizes and configurations. Fittings certified to NSF/ANSI are found on Pages 4-39 and tubing certified to NSF/ANSI 51 & 61: Pages 119-125



Products which have received certification for contact with food and beverages for human consumption



Products which have received certification for contact with drinking water



Products which have received certification for contact with food, beverages and drinking water

Transparent Polyurethane Tubing

Ether Formula Polyurethane

RoHS Compliant

Part Number	ID	OD	Working PSI @70°F	Burst PSI @70°F	Wall Thickness	
210 0070-100	1/16"	1/8"	134	402	1/32"	•
210 0147-100	1/8"	3/16"	72	216	1/32"	•
210 0224-100	1/8"	1/4"	130	390	1/16"	•
210 0455-100	3/16"	5/16"	74	222	1/16"	•
210 0686-100	1/4"	3/8"	67	201	1/16"	•
210 0840-100	1/4"	1/2"	131	393	1/8"	•
210 0917-100	5/16"	7/16"	65	195	1/16"	•
210 1148-100	3/8"	1/2"	59	177	1/16"	•
210 1225-100	3/8"	9/16"	84	252	3/32"	•
210 1302-100	3/8"	5/8"	100	300	1/8"	•
210 1533-100	1/2"	5/8"	36	108	1/16"	•
210 1610-100	1/2"	11/16"	48	144	3/32"	•
210 1687-100	1/2"	3/4"	60	180	1/8"	•
210 1764-100	5/8"	3/4"	40	120	1/16"	•
210 1841-100	5/8"	13/16"	54	162	3/32"	•
210 1918-100	5/8"	7/8"	60	180	1/8"	•
210 2072-100	3/4"	1"	51	153	1/8"	•
210 2380-100	1"	1 1/4"	40	120	1/8"	•

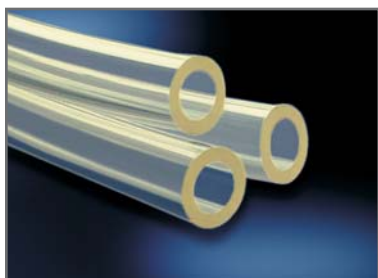

- Hardness, Shore A 85 ± 5
- Contains no plasticizers
- Brittle temperature – 90°F • Max operating temperature 175°F
- Resistant to most oils, fuels and greases (*testing is recommended)
- Ether formulation resists attack from moisture, fungus and radiation
- UV stable – good for outdoor use • Excellent resistance to weathering, impact, abrasion and repeated flexing
- Ether-based material is listed by National Sanitation Foundation NSF 61

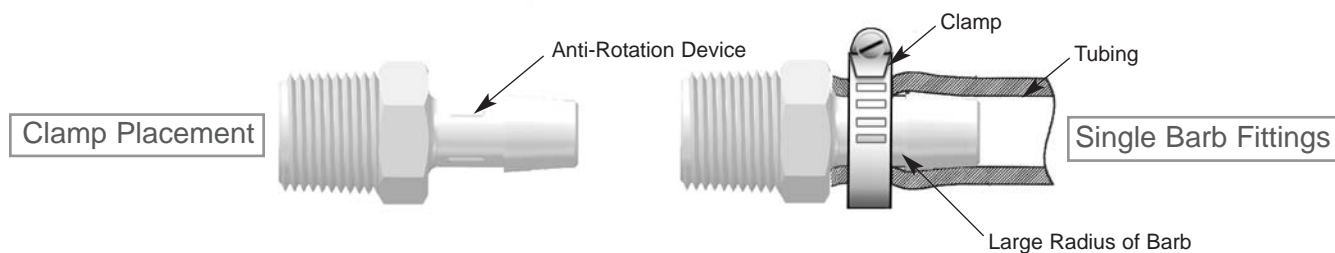

Placing the clamp behind a fitting's barb achieves the most secure and leak resistant seal with the tubing. This is only possible when using fittings designed with a single barb.

Eldon James

Clear PVC Tubing

RoHS Compliant

Part Number	ID	OD	Working PSI @70°F	Burst PSI @70°F	Wall Thickness	
110 0456-100	1/8"	1/4"	68	212	1/16"	•
110 0918-100	3/16"	5/16"	55	220	1/16"	•
110 0995-100	3/16"	3/8"	70	280	3/32"	•
110 1149-100	1/4"	3/8"	55	220	1/16"	•
110 1226-100	1/4"	7/16"	60	240	3/32"	•
110 1303-100	1/4"	1/2"	70	280	1/8"	•
110 1380-100	5/16"	7/16"	50	200	1/16"	•
110 1457-100	5/16"	1/2"	60	240	3/32"	•
110 1611-100	3/8"	1/2"	40	160	1/16"	•
110 1765-100	3/8"	5/8"	65	260	1/8"	•
110 2227-100	1/2"	5/8"	30	120	1/16"	•
110 2304-100	1/2"	11/16"	40	160	3/32"	•
110 2381-100	1/2"	3/4"	45	180	1/8"	•
110 2920-100	5/8"	3/4"	48	192	1/16"	•
110 3074-100	5/8"	7/8"	40	160	1/8"	•
110 3536-100	3/4"	7/8"	19	76	1/16"	•
110 4152-100	1"	1 1/4"	28	112	1/8"	•



- Hardness, Shore A 68 ± 5
- PVC compound meets USP Class VI requirements
- Brittle temperature – 41°F • Max operating temperature 175°F
- Handles a wide variety of chemicals, gasses and liquids
- Generally unaffected by most oxidizing and reducing agents
- Oils and gasoline will harden PVC over periods of intermittent use
- Listed by the National Sanitation Foundation NSF 51

Fuel and Oil Resistant PVC Tubing

RoHS Compliant

Part Number	ID	OD	Working PSI @70°F	Burst PSI @70°F	Wall Thickness	
111-0032-50	1/8"	1/4"	68	204	1/16"	•
111-0067-50	3/16"	5/16"	55	165	1/16"	•
111-0102-50	1/4"	3/8"	55	165	1/16"	•
111-0137-50	3/8"	1/2"	40	120	1/16"	•

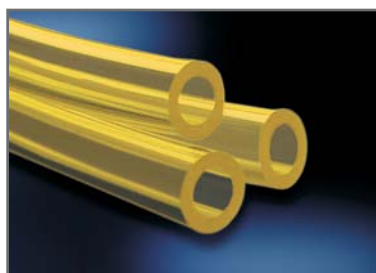

- Hardness, Shore A 68 ± 5
- Brittle temperature – 41°F (– 41°C)
- Max operating temperature +175°F (+80°C)
- Generally unaffected by most oxidizing and reducing agents
- Specially formulated to remain flexible when used with fuels and oils

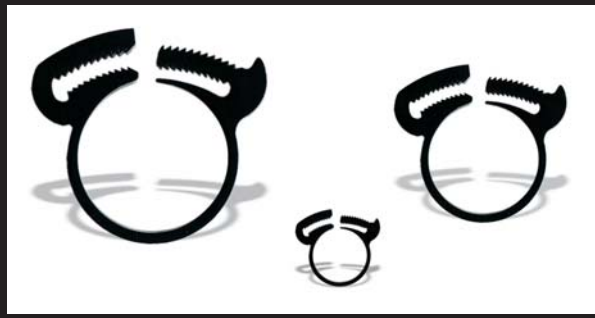

Handy Clamps

Part Number	Max. Diameter	Min. Diameter	3 Teeth Engaged	Sets of Teeth	Fits Flexelene™ FX and Silver FXAG Tubing			
HC-A	.268 [9/32"]	.220 [7/32"]	0.256"	8	FX 2-4*	•	•	•
HC-AA	.319 [5/16"]	.256 [9/32"]	0.311"	8	FX 3-5*	•	•	•
HC-B	.378 [3/8"]	.311 [5/16"]	0.362"	8	—	•	•	•
HC-BB	.425 [7/16"]	.362 [3/8"]	0.406"	9	FX 4-6*	•	•	•
HC-C	.484 [1/2"]	.402 [13/32"]	0.465"	9	FX 5-7*	•	•	•
HC-D	.571 [9/16"]	.472 [15/32"]	0.543"	9	FX 6-8*	•	•	•
HC-F	.701 [23/32"]	.591 [19/32"]	0.673"	11	FX 8-10*	•	•	•
HC-G	.783 [25/32"]	.665 [21/32"]	0.752"	11	FX 8-12*	•	•	•
HC-H	.843 [27/32"]	.713 [23/32"]	0.811"	11	FX 10-12*	•	•	•
HC-J	.933 [31/32"]	.799 [13/16"]	0.906"	11	FX 12-14*	•	•	•
HC-K	1.016 [1 1/32"]	.874 [7/8"]	0.980"	11	FX 12-16*	•	•	•
HC-N	1.299 [1 5/16"]	1.134 [1 1/8"]	1.268"	11	FX 16-20*	•	•	•

* Size tests were made using Eldon James "single barb fittings". The space behind a single barb allows for more compression of the tubing than is allowed by a multiple barb. With a multiple barb fitting, the clamp sits on top of the barb flanges and a larger clamp may be required - If in doubt about size, please ask for samples.

Nylon 6.6

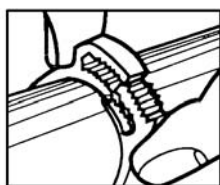

Engage

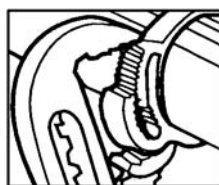

Secure

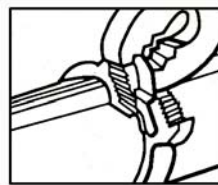

Remove



Clip size is molded on each clamp

Larger sizes to 6" diameter are available by special order.

Size Selection Guideline:

With the hose in place on the fitting, select a Handy Clamp that provides a snug fit with one to three teeth engaged. When fully tightened this will produce a strong and reliable closure.



← Line production assembly tool for Handy Clamps HC-ATM \$250.00

Stainless Steel Tubing Clamps



Oetiker Stepless Ear Clamps

- Radial Compression 360° - no steps or gaps on inner circumference
 - Ear design provides spring action during vibration and thermocycling conditions
 - Chromium-nickel stainless steel has a high strength-to-weight ratio
 - Excellent corrosion resistance in both aqueous and atmospheric environments
- Oetiker Stepless Ear Clamps are made of UNS S30400 or DIN 1.4301 stainless steel.

Other sizes are available by special order.

7 mm x 0.6 mm Band dimension except number **16700989 and **16700988, which measure 5 mm x 0.5 mm

Part Number	Clamping Range		* Use with Eldon James Flexelene™ Tubing Size			•	•
	Inches closed • open	mm closed • open	Eldon James Tubing Size	OD Nominal			
**16700988	.347 - .413	8.8 - 10.5 mm	MFX	4 - 6	3/8"	•	•
**16700989	.378 - .445	9.6 - 11.3 mm	FX, FXAG	4 - 6	3/8"	•	•
16700992	.386 - .484	9.8 - 12.3 mm	FX, FXAG	5 - 7	7/16"	•	•
16700993	.425 - .524	10.8 - 13.3 mm	—	—	—	•	•
16700997	.453 - .551	11.5 - 14.0 mm	FX, MFX, FXAG	6 - 8	1/2"	•	•
16701005	.520 - .618	13.2 - 15.7 mm	—	—	—	•	•
16701009	.571 - .669	14.5 - 17.0 mm	—	—	—	•	•
16701015	.602 - .728	15.3 - 18.5 mm	FX, FXAG	8 - 10	5/8"	•	•
16701021	.654 - .780	16.6 - 19.8 mm	FX, FXAG	8 - 12	3/4"	•	•
16701029	.701 - .827	17.8 - 21.0 mm	FX	10 - 12	3/4"	•	•
16701058	.823 - .949	20.9 - 24.1 mm	—	—	—	•	•
16701072	.882 - 1.008	22.4 - 25.6 mm	FX	12 - 14	7/8"	•	•
16701087	.941 - 1.067	23.9 - 27.1 mm	—	—	—	•	•
16701103	1.000 - 1.126	25.4 - 28.6 mm	—	—	—	•	•
16701225	1.236 - 1.362	31.4 - 34.6 mm	FX	16 - 20	1 1/4"	•	•
16701245	1.295 - 1.421	32.9 - 36.1 mm	—	—	—	•	•

SELECTING THE CORRECT SIZE : SELECT THE NOMINAL SIZE NEAREST TO, BUT ALWAYS LARGER THAN THE OUTSIDE DIAMETER OF THE MATERIAL TO BE CLAMPED. THE OUTSIDE DIAMETER SHOULD BE DETERMINED WITH CONNECTION FULLY ASSEMBLED. NOTE: MULTIPLE BARB FITTINGS MAY REQUIRE USING A LARGER CLAMP SIZE THAN SINGLE BARB FITTINGS - TO CONSIDER THE CLAMP CLOSED - THE EAR WIDTH SHOULD BE REDUCED BY AT LEAST 40% WHEN PINCHED.



Standard Jaw Pincers

For closing all regular Oetiker Stepless Clamps



Part Number
1410082
\$18.00

Dual Purpose Side Jaw Pincers

Designed for working in tight areas with pliers held parallel to the hose - can also be used from the front like regular pincers.



Part Number
1410083
\$21.00

Eldon James

Stainless Steel Tubing Clamps

Oetiker



Worm Drive Clamps

Part Number	Clamping Range				
	inches	mm			
17700049	5/16" - 1/2"	8 - 16 mm	•	•	•
17700050	1/2" - 3/4"	12 - 20 mm	•	•	•
17700051	5/8" - 1 1/16"	16 - 27 mm	•	•	•
17700052	3/4" - 1 1/4"	20 - 32 mm	•	•	•

1/4" Hex-Head Screw Clamps

300 Series stainless steel band and housing. Zinc-plated, yellow chromate, carbon steel screw.

Ideal



Part Number	Clamping Range			
	inches	mm		
62606	.312" - .875"	7.97 - 22.2	•	•
62M08	.500" - 1.00"	12.7 - 25.4	•	•
62M12	.625" - 1.25"	15.8 - 31.7	•	•
62M16	.625" - 1.50"	15.8 - 38.1	•	•

Tiny, tough, precision engineered • Seal with only 10 inch-pounds of screw torque • One-piece housing • No spot welds • Easy to install in confined areas

Oetiker clamps illustrated below are available as special order items - Please call for a quote.



Oetiker Miniature Clamps



Constant Tension Clamps



2-Ear Clamps



1-Ear Clamps

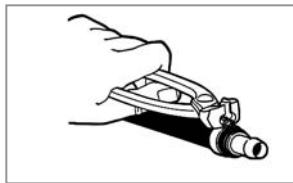
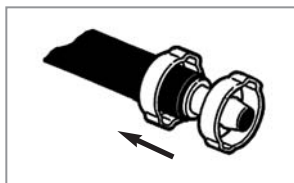

Removal
(Stepless Ear Clamp)



General Purpose Fittings Kits

Black Nylon • Natural Polypropylene • Natural Kynar® • High Density Polyethylene



Kit content details can be found at www.eldonjames.com



EJK202 Kit • Threaded Elbows, Tees, Nipples & Plug

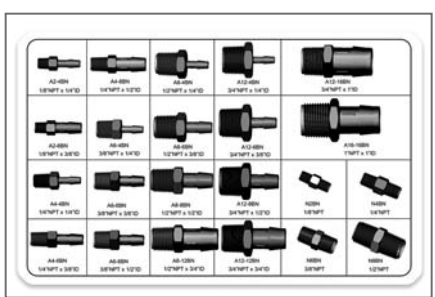

EJK138 Kit • Adapter Kit



 EJK203 Kit
British Standard Pipe Threads

EJK 202 Kit	Black Nylon	Polypropylene	Natural Kynar®	HDPE
36 fittings - 2 per size	EJK 202 BN	EJK 202 NP	EJK 202 NK	EJK 202 HDPE

EJK 138 Kit	Black Nylon	Polypropylene	Natural Kynar®	HDPE
44 fittings - 2 per size	EJK 138 BN	EJK 138 NP	EJK 138 NK	EJK 138 HDPE

EJK 203 Kit	Black Nylon	Polypropylene	Natural Kynar®	HDPE
48 fittings - 2 per size	EJK 203 BN	EJK 203 NP	EJK 203 NK	EJK 203 HDPE



Eldon James Automotive Repair Kits
See Following Page



Automotive & Marine Component Kits

Fuel Line Kit - EJK 146



Heater Hose Kit EJK 145
bottom of Page

Fuel Line Kit
#EJK 146
\$22.00

C0-1.5BN 3/32" ID	C0-2BN 1/8" ID	C0-2.5BN 5/32" ID	C0-3BN 3/16" ID	C2-1.5BN 1/8" x 3/32" ID	YO-2BN 1/8" ID
L0-1.5BN 3/32" ID	L0-2BN 1/8" ID	L0-2.5BN 5/32" ID	L0-3BN 3/16" ID	C2-5-2BN 5/32" x 1/8" ID	YO-3BN 3/16" ID
T0-1.5BN 3/32" ID	T0-2BN 1/8" ID	T0-2.5BN 5/32" ID	T0-3BN 3/16" ID	C4-3BN 3/16" 1/4" ID	YO-4BN 1/4" ID

36 Assorted Fittings (2 each)

Compartmentalized kits keep fittings organized and make size selection easy

Heater Hose Kit - EJK 145



Cooling System
Heater Hose Kit
#EJK 145
\$30.50

Fuel Line Kit EJK 145 - top of page

 C0-6GFBN 1/2" x 3/8" I.D.	 C0-8GFBN 1/2" I.D.	 T0-8GFBN 1/2" I.D.	 C0-4GFBN 3/8" I.D.	 C0-4GFBN 1/4" I.D.	
 C10-6GFBN 5/8" x 1/2" I.D.	 L0-10GFBN 5/8" I.D.	 L0-8GFBN 1/2" I.D.	 T0-6GFBN 3/8" I.D.	 T0-4GFBN 1/4" I.D.	
			 L0-6GFBN 3/8" I.D.	 L0-4GFBN 1/4" I.D.	

Features:

- 36 Eldon James *single barb* premium **Glass-Filled Black Nylon** fittings
1/4", 3/8", 1/2", 5/8", 3/4" hose IDs
 - Dual access compartmentalized tackle box with handle - keeps fittings organized for easy access. Fitting configurations and sizes are illustrated on the inside of top and bottom lids
- 36 Fittings (2 each)

 T0-10GFBN 5/8" I.D.	 C0-10GFBN 5/8" I.D.	 C12-10GFBN 3/4" x 5/8" I.D.	 C0-12GFBN 3/4" I.D.	 L0-12GFBN 3/4" I.D.	 T0-12GFBN 3/4" I.D.
----------------------------	----------------------------	------------------------------------	----------------------------	----------------------------	----------------------------

Component contents of kits are listed on our website – www.eldonjames.com



Chemical Resistance of Materials

A = Excellent (No Effect) B = Good (Minor Effect) C = Fair (Moderate Effect) D = Poor (Severe Effect)

Qualifiers: • 1 = Satisfactory to 72°F (22°C) • 2 = Satisfactory to 120°F (48°C)

SS = Stainless Steel

Chemical	HDPE	LDPE	NYLON	POLYCARBONATE	POLYPROPYLENE	KYNAR®	316L SS
Acetaldehyde	C	C	A	C1	A1	D	A
Acetamide	A	A	A	D	A1	C	A
Acetate Solvent	A	A	A	-	B1	A	A
Acetic Acid:							
80%	A	D	D	B1	A	C	B
20%	A	A	D	A1	A	A	A
Glacial	A	D	B	B1	A1	A1	A
Vapors	-	-	D	-	-	A	D
Acetone	D	B1	A	D	A	D	A
Acetylene	-	D	A	D	A1	A	A
Acrylonitrile	A	A	A1	D	A1	A1	A1
Alcohols:							
Benzyl	B	D	B1	-	A	A	B
Ethyl	A	B	A1	B2	A	-	A
Isopropyl	A	A2	D	A2	A2	-	B
Methyl	A	A1	B1	B1	A2	A	A
Propyl	-	A2	D	-	A	A2	A
Allyl Chloride	A	-	-	-	A	A	A
Aluminum Fluoride	A	A2	A1	-	A	A	D
Aluminum Hydroxide	A	A2	A1	B1	A	A	C1
Aluminum Nitrate	-	A2	A1	A1	A2	A2	A
Aluminum Sulfate	A	A2	A2	A	A	A	B2
Alums	-	A	A	-	A	-	A
Aluminum Sulfate	A	A2	A2	A	A	A	B2
Amines	B	C1	D	D	B2	-	A
Ammonia 10%	A	C1	A	D	A2	A	A
Ammonia, Anhydrous	A	B2	A1	D	A	A	A2
Ammonia, liquid	A	C1	B1	D	A2	A	A2
Ammonium Acetate	A	A	A	-	A	-	A
Ammonium Bifluoride	-	A2	-	-	A	A	B1
Ammonium Carbonate	B	B2	A1	-	A	A	B
Ammonium Chloride	A	A2	B	A2	A	A	B2
Ammonium Hydroxide	A	A1	A	D	A	A	A1
Ammonium Nitrate	A	A1	A1	-	A	A	A
Ammonium Persulfate	A	A2	D	-	A	A1	B
Ammonium Phosphate:							
Dibasic	-	A2	C1	A2	A	A	C
Monobasic	-	A	B	-	A	-	C
Tribasic	-	C	B	-	A	-	B
Ammonium Sulfate	A	A1	A1	A2	A	A	B
Ammonium Thiosulfate	-	A	-	-	-	-	A

Chemical	HDPE	LDPE	NYLON	POLYCARBONATE	POLYPROPYLENE	KYNAR®	316L SS
Amyl Alcohol	A	B2	A1	B1	B1	A	A
Aqua Regia 80% HCL-20% HNO ₃	D	B1	D	D	B1	A2	D
Asphalt	-	A1	A	D	B1	A	A
Barium Hydroxide	-	B2	A1	D	B	A	B
Barium Sulfate	B	B2	A1	D	B1	A	B1
Barium Sulfide	A	B2	A1	-	B	A	B2
Beer	A	A2	A1	A2	A1	A	A
Benzaldehyde	B	A1	A1	D	D	A2	B
Benzene	D	D	A1	D	D	A2	B
Benzene Sulfonic Acid	A	A1	D	D	D	-	B
Benzoic Acid	A	A1	D	B1	B1	A	B
Benzyl Chloride	-	-	A2	-	C1	-	B1
Bleach	-	-	A	-	D	A	A
Borax (Sodium Borate)	A	A2	A	-	B	A	A
Boric Acid	A	A2	B	-	A	A	A1
Bromine	D	D	D	C1	D	A	D
Butadiene	D	D	C1	D	C	A	A1
Butane	-	C1	A2	D	A1	A	A2
Butanol (Butyl Alcohol)	-	B2	B1	B1	A1	A	A1
Butyl Amine	-	C1	A2	D	B1	A1	A
Butyl Ether	-	-	A2	-	D	A1	A1
Butylene	-	B1	B1	D	-	A	A
Butyric Acid	D	D	C1	D	B1	A	B2
Calcium Carbonate	-	B1	A	C2	A	A	B
Calcium Chloride 30% in water	A	B2	A1	-	A2	A	B2
Calcium Hydroxide 10%	A	-	A	-	A	A	B
Calcium Hydroxide (saturated)	A	-	A	-	A	A	B
Calcium Hypochlorite 30%	A	-	-	-	A	A	B
Calcium Nitrate	B	A1	A1	A2	A2	A2	B2
Calcium Oxide	-	B1	B	-	A	A	A
Calcium Sulfate	A	B1	D	A2	A	A	B
Carbolic Acid (Phenol)	-	D	D	D	B	A1	B
Carbon Dioxide (Dry)	-	A1	A1	-	A2	A	A1
Carbon Monoxide	-	A2	A1	-	A	B	A
Carbonated Water	-	A	A	-	B	-	A
Carbonic Acid	B	B2	A1	A1	A	A	A
Chlorine Water	C	B1	C1	-	D	B	C
Chlorine, Anhydrous Liquid	C	D	D	C	D	A1	C
Chlorine (dry)	B	D	D	-	D	A	B
Chloroacetic Acid	A	D	D	D	C1	A1	A1
Chlorobenzene (Mono)	D	C1	D	D	C1	A1	B

** Please read the safety disclaimer notes on page 142 **

Chemical Resistance of Materials

A = Excellent (No Effect) B = Good (Minor Effect) C = Fair (Moderate Effect) D = Poor (Severe Effect)

Qualifiers: • 1 = Satisfactory to 72°F (22°C) • 2 = Satisfactory to 120°F (48°C)

SS = Stainless Steel

Chemical	HDPE	LDPE	NYLON	POLYCARBONATE	POLYPROPYLENE	KYNAR®	316L SS
Chlorobromomethane	-	A	C	-	A	-	-
Chlorosulfonic Acid	D	D	D	C1	D	D	B2
Citric Acid	A	D	A1	A1	A	A	A2
Citric Oils	B	-	-	-	A	-	A
Clorox® (Bleach)	-	-	A	-	D	A	-
Coffee	-	-	A	-	A	-	A
Copper Chloride	-	-	D	-	A	A	D
Copper Sulfate 5%	A	A2	D	A1	A	A	B
Cresols	D	C1	D	D	D	A2	A
Cyclohexane	D	B1	A	B	D	A	A
Cyclohexanone	B	D	A	D	D	D	A2
Detergents	A	D	A1	A1	A	A	A1
Dextrin	A	-	-	-	A	A	B
Diacetone Alcohol	A	A	A1	D	A1	D	B
Dichloroethane	C	C1	A1	D	D	A	B
Diesel Fuel	D	C1	D	A2	A1	A	A1
Diethyl Ether	D	-	A1	D	A1	A1	B2
Diethylamine	D	D	A	D	A1	D	A
Disodium Phosphate	A	-	-	-	A	A	A
Ethane	-	-	D	-	D	A	A1
Ethanol	A	B	A1	B2	A	-	A
Ethanolamine	-	-	A	-	D	C1	A
Ether	D	D	A	-	D	B1	A
Ethyl Acetate	A	A	A2	D	A1	D	B
Ethyl Benzoate	B	C2	-	D	B1	D	-
Ethyl Chloride	C	C1	A1	D	D	A	A
Ethyl Ether	D	D	A1	-	D	A2	B
Ethylene Glycol	A	A2	A	B1	A	A	B
Ethylene Oxide	B	A	A1	C1	D	A	B
Fatty Acids	A	D	A1	B1	A	A	A
Ferric Chloride	D	A1	A	A2	A	A	D
Ferric Nitrate	-	A2	A1	A1	A	A	B
Ferric Sulfate	-	A2	A1	A1	A	A	A
Ferrous Sulfate	-	A2	D	A1	A	A	B
Formaldehyde 40%	A	D	A	A1	A	A	A
Formic Acid	A	D	D	A1	A1	A	A1
Fruit Juice	-	A	A	-	B	A	A
Fuel Oils	C	B	A1	B1	A	B	A
Furfural	A	D	B	D	D	B2	B
Gallic Acid	A	A	A	-	A	A1	B
Gasoline (high-aromatic)	B	A	A	A	A	A	A

Chemical	HDPE	LDPE	NYLON	POLYCARBONATE	POLYPROPYLENE	KYNAR®	316L SS
Gasoline, unleaded	B	-	A2	A2	C1	A	A2
Glucose	A	A2	A	A1	A	A	A
Glue, P.V.A	A	A1	A1	-	-	-	A2
Glycerine	A	A1	A1	A2	A	A	A
Glycolic Acid	-	A2	-	-	A	B	A
Heptane	B	B1	A	B	C2	A	A
Hexane	C	D	B	D	B1	A	A
Honey	-	B	A	A1	A	A	A
Hydraulic Oil (petroleum)	A	C	A1	-	D	A	A
Hydraulic Oil (synthetic)	A	A	A1	-	D	A	A
Hydrazine	D	-	-	D	C	A	A
Hydrochloric Acid 20%	A	A2	D	B1	B2	A	D
Hydrochloric Acid 100%	D	-	D	D	B1	A	D
Hydrofluoric Acid 50%	A	A1	D	D	A2	A	D
Hydrofluosilicic Acid 20%	B	B2	D	-	A	A	B1
Hydrogen Gas	A	A2	A2	A2	A	A	A
Hydrogen Peroxide 10%	A	A	C1	A2	A	A	B
Hydrogen Peroxide 50%	A	C2	D	A2	B1	A1	A2
Hydrogen Sulfide (aqua)	A	A	C1	A	A1	A	A
Hydroquinone	-	A	D	-	A	-	B
Hydroxyacetic Acid 70%	-	A	-	-	-	A	-
Iodine	B	A1	A	-	C	A2	D
Iodine (in alcohol)	B	B	C	-	-	A	-
isooctane	B	B	A1	B1	A2	A2	A1
Isopropyl Acetate	B	B1	B1	D	B1	D	A
Jet Fuel (JP3, JP4, JP5)	D	D	C	A1	A1	B	A
Kerosene	B	C1	A	D	B	A	A
Ketones	D	C1	A2	D	C	C1	A
Lacquer Thinner	D	A	A1	B	D	-	A
Lacquer	D	A	A1	D	D	D	A
Lactic Acid	A	A1	B	B	B	B1	B1
Latex	-	-	A1	-	A2	A	A2
Ligroin	-	A	D	-	A2	A	A
Lime	-	A	A1	-	-	A	A
Linoleic Acid	-	A	-	-	B1	A2	A
Lithium Hydroxide	D	-	-	D	-	-	B
Lubricants	B	D	A1	A1	A1	A	A2
KOH Potassium Hydroxide	B	A	C	D	A	A	A1
NaOH Sodium Hydroxide	B	D	A	D	A	D	B1
Magnesium Bisulfate	-	-	A1	A1	A2	-	A
Magnesium Chloride	A	A1	A1	A2	A2	A	D

** Please read the safety disclaimer notes on page 142**

Chemical Resistance of Materials

A = Excellent (No Effect) B = Good (Minor Effect) C = Fair (Moderate Effect) D = Poor (Severe Effect)

Qualifiers: • 1 = Satisfactory to 72°F (22°C) • 2 = Satisfactory to 120°F (48°C)

SS = Stainless Steel

Chemical	HDPE	LDPE	NYLON	POLYCARBONATE	POLYPROPYLENE	KYNAR®	316L SS
Magnesium Hydroxide	B	A2	B1	A1	A	A	A1
Malic Acid	-	B2	A	-	A1	A	A2
Methane	-	-	A	-	A	A	A
Methanol (Methyl Alcohol)	A	A1	B1	B1	A2	A	A
Methyl Alcohol 10%	A	A1	B1	B1	A2	A	A
Methyl Cellosolve	-	-	C	D	B	A	B
Methyl Chloride	-	C1	B1	D	D	A	A
Methyl Ethyl Ketone	D	D	A1	D	B2	D	A
Methyl Isobutyl Ketone	D	C	B2	D	A	D	B
Methyl Isopropyl Ketone	-	D	A	D	-	-	A
Methyamine	-	A1	-	-	A2	C	A
Methylene Chloride	D	D	C1	D	B1	B1	B
Milk	-	A	A	A	B	A2	A
Mineral Spirits	D	B	A	C	B	-	A
Monochloroacetic Acid	D	-	D	D	-	B1	A1
Monoethanolamine	-	C	A	-	B	C	A
Morpholine	-	-	A2	D	B2	B1	A1
Motor Oil	-	C1	A2	A	A1	B	A2
Naphtha	-	A1	A	B	B	A	A
Natural Gas	-	A	-	-	A	-	A
Nitric Acid (5-10%)	A	B	D	A	A	A1	A
Nitric Acid (20%)	B	C	D	B1	A2	A	A
Nitric Acid (50%)	D	B1	D	B	B	A1	A1
Nitrobenzene	D	C1	B1	D	B1	A1	B
Nitromethane	D	A	B1	D	B2	A2	A1
Nitrous Oxide	-	C	C	-	D	D	B
Oils:							
Citric	-	A	A	A	A	A	A
Corn	-	A	A	-	A2	A	A
Cottonseed	-	A	B	-	A	A	A
Crude Oil	D	-	A	-	A	A	A
Fuel (1, 2, 3, 5A, 5B, 6)	-	B	A	B	B	B	A
Diesel Fuel (20, 30, 40, 50)	-	A	A	-	A1	A	A
Silicone	A	A	A1	-	A	A	A
Turbine	-	C	A	-	B1	A	A
Oleic Acid	C	C2	A	-	B1	A	A
Oxalic Acid (cold)	A	A2	B2	-	A2	B	A
Ozone	A	C1	D	A1	B	A	A
Palmitic Acid	-	-	A	-	B1	A2	A1
Paraffin	B	B	A1	A1	A1	A	A
Pentane	-	D	A1	A	D	A	A

Chemical	HDPE	LDPE	NYLON	POLYCARBONATE	POLYPROPYLENE	KYNAR®	316L SS
Perchloric Acid	D	B	D	-	C	A	C
Petroleum	D	C1	A1	-	B1	A	A1
Phenol (10%)	D	B	D	B1	B1	A	B
Phenol (Carbolic Acid)	D	D	D	D	B	A1	B
Phosphoric Acid (<40%)	A	A	B1	A	A2	B	C
Phosphoric Acid (>40%)	A	B1	B1	A	A2	B	D
Plating Solutions							
Copper Sulfate Bath R.T.	-	-	D	-	A	A	D
Gold Plating (Acid 75°F)	-	-	A	-	A	-	C
Silver Plating (80°F-120°F)	-	-	A	-	A	-	A
Potassium Bicarbonate	B	A	A1	-	A	B	B
Potassium Bromide	B	A	A1	A1	A	A	B
Potassium Chloride	A	A1	A1	A	A	A	A1
Potassium Dichromate	B	A	B1	A1	A	A	B1
Potassium Ferricyanide	-	A2	B1	-	A2	A2	B1
Potassium Hydroxide	A	A	C1	D	A	A	A1
Potassium Iodide	B	B1	A1	-	A2	A2	A1
Potassium Nitrate	B	A	B1	A1	A	A	B
Potassium Permanganate	A	A	D	A2	A1	A	B
Propane (liquefied)	D	C1	A1	C1	A	A	A
Propylene Glycol	A	B2	A	B1	A2	-	B
Pyridine	D	B1	C1	D	A2	D	A
Resorcinol	-	B2	D	B1	A2	-	-
Rosins	B	B1	A1	-	A2	-	A1
Salicylic Acid	-	B2	A1	A1	A1	A	B2
Sea Water	A	A2	A2	A2	A	A	C
Shellac (Orange)	-	A1	A1	-	A	-	A
Silicone	-	-	A1	A2	A	A	A
Silver Bromide	-	A	-	-	-	-	D
Silver Nitrate	A	A	A1	A2	A1	A	B
Soap Solutions	B	D	A1	A1	A	A1	A1
Sodium Acetate	A	A	B1	A1	A	A	B1
Sodium Benzoate	B	A2	B1	A2	A2	A2	-
Sodium Bicarbonate	A	A2	A	A2	A	A	A1
Sodium Bisulfate	B	A2	A1	A1	A	A	C
Sodium Bisulfite	B	A2	C1	A1	A	A	B1
Sodium Borate (Borax)	B	A2	A1	A1	A2	A	B
Sodium Bromide	-	A2	B1	-	-	A2	C
Sodium Carbonate	A	B2	B1	A2	A	A	A
Sodium Chlorate	-	B2	D	A1	A	A	B1
Sodium Chloride	A	A2	A1	A2	A	A	B

** Please read the safety disclaimer notes on page 142 **

Chemical Resistance of Materials

A = Excellent (No Effect) B = Good (Minor Effect) C = Fair (Moderate Effect) D = Poor (Severe Effect)

Qualifiers: • 1 = Satisfactory to 72°F (22°C) • 2 = Satisfactory to 120°F (48°C)

SS = Stainless Steel

Chemical	HDPE	LDPE	NYLON	POLYCARBONATE	POLYPROPYLENE	KYNAR®	316L SS
Sodium Hydrosulfite	-	-	A	-	-	-	-
Sodium Hydroxide							
(20%)	C	B	A	A2	A	A	B2
(50%)	C	B	A	D	A	D	B1
(80%)	C	-	C	D	A	D	B1
Sodium Hypochlorite (100%)	C	B2	D	-	B	A	D
Sodium Hypochlorite (<20%)	A	A	D	C	A	A	C
Sodium Nitrate	B	A2	A1	-	A	A	B1
Sodium Perborate	-	A1	B1	-	A	-	B
Sodium Polyphosphate	B	A	A1	-	A	A	B
Sodium Silicate	A	A2	A1	-	A	A	B
Sodium Sulfate	-	A2	A	A2	A	A	B1
Sodium Sulfite	B	B1	D	-	A2	A	A
Sodium Tetraborate	B	A2	A	-	-	-	A
Sodium Thiosulfate	-	A1	B	D	A2	A	B
Stearic Acid	A	B1	A2	A1	A2	A	A
Stoddard Solvent	-	C2	A	A2	C	A	A
Styrene	-	-	A1	D	-	-	A
Sulfate (Liquors)	A	A2	B1	-	A	A	B
Sulfur Dioxide	D	B1	C1	-	A1	A	A1
Sulfur Trioxide	-	-	D	-	C	-	C
Sulfur Hexafluoride	-	B	B	-	-	-	-
Sulfuric Acid							
Sulfuric Acid (<10%)	A	A1	C1	A1	A2	A	B

Chemical	HDPE	LDPE	NYLON	POLYCARBONATE	POLYPROPYLENE	KYNAR®	316L SS
Sulfuric Acid (10-75%)	A	A1	D	B1	A1	A	D
Sulfuric Acid (cold concentrated)	B	D	D	-	A2	A	B
Sulfuric Acid (hot concentrated)	B	D	D	D	D	C	C
Sulfurous Acid	B	B2	D	-	A	A	B
Tannic Acid	A	B2	C1	C	A	B	A
Tetrahydrofuran	C	C1	A	D	C2	B1	A
Tetrachloroethane	-	-	C1	-	C	A	A
Toluene (Toluol)	D	C1	A1	D	C1	A1	A
Trichloroacetic Acid	C	A	C	D	A	B	C
Trichloroethylene	D	D	C1	-	C1	B	B
Tricresylphosphate	-	B1	A2	-	A1	D	B
Triethylamine	-	-	A1	-	D	A2	A
Trisodium Phosphate	A	A	A	-	A	A	B
Turpentine	B	D	B	D	D	A	A
Urea	A	A	A	D	A	A	B
Vegetable Juice	-	-	A	-	-	-	A
Vinegar	A	A	A	A2	A	B	A
Water, Deionized	A	-	A1	-	A2	A2	A2
Water, Distilled	A	A2	A1	A2	A	A	A
Water, Fresh	A	A2	A1	A2	A	A	A
Water, Salt	A	A2	A2	A2	A	A	B
Weed Killers	-	-	A	-	-	-	A
Whiskey & Wines	B	C	A1	A1	A	A	A
Zinc Sulfate	A	A2	A	A2	A	A	A

Disclaimer and Safety Warning: The data presented in this publication is for reference only.

It was compiled primarily from outside sources provided by feedstock materials suppliers and resin manufacturers, and is offered to our customers as a means of comparing the characteristics of resins and materials used by Eldon James Corp. at the time of publication. The particular conditions of your use and application of our products are beyond our control; therefore, it is imperative that products be tested in your specific application to determine their ultimate suitability. All information is provided without implied or expressed warranty or guarantee by Eldon James Corp, or the resin and feedstock manufacturers. Eldon James Corp. assumes no liability with respect to the accuracy or completeness of the information contained herein and none of the information provided constitutes a recommendation or endorsement of any kind by the Eldon James Corp.



An extended listing of chemical resistance can be found on our
Website @ eldonjames.com
> Technical

Terms and Conditions of Sale

Specific Terms and Conditions

Visa, MasterCard, or American Express credit cards are gladly accepted. Credit accounts will be established on a Net 30 basis upon submission and approval of the Eldon James Terms and Conditions Acknowledgement Agreement. This form is available on-line in printable PDF format @www.eldonjames.com > Orders > Online Credit Application or can be faxed, or sent as a PDF e-mail attachment from our office.

Minimum Orders: Qualified minimum orders (see below) are \$50.00. PVC and Polyurethane tubing orders require a minimum \$100.00 purchase.

Orders on account are accepted (\$50 Minimum) if the purchaser has no outstanding invoices older than 30 days and has a consistent on-time payment history. Orders for less than \$50 are accepted with a credit card, subject to approval. Delinquent accounts may result in denial of credit. Accounts over 90 days past due are subject to action by a third party collection service.

Freight Policy: All shipments are F.O.B. Loveland, Colorado. Shipping charges are pre-paid and added to the invoice unless other arrangements are made by the customer prior to shipment. Standard shipping is by FedEx ground unless a UPS or another shipper account number is provided at the time the order is placed.

Export Orders: Invoices may be paid using one of three methods:

- 1) Visa, MasterCard, or American Express credit cards - CC authorization required
- 2) Payment by check drawn from an account at a US bank denominated in US dollars
- 3) Wire transfers denominated in USD are also welcome. All bank charges are the customer's responsibility. Contact Eldon James Customer Service 001 (970) 667-2728, 8:00 am to 5:00 pm MST, for specific bank and account information.

Quality Certifications: Many Eldon James' standard materials meet USP Class VI and FDA requirements or are NSF certified. Eldon James Corp. offers Certificates of Traceability and/or Certificates of Conformance on products made from these materials. Certificates must be requested at the time the order is placed - We cannot assign certificates for orders which have already left our facility.

Returned Goods: Goods will not be accepted for return after 30 days. All returned goods must be standard stocked products. Special materials fittings, fittings made from Natural Materials (NN, NK, NP, HDPE, LDPE) and Flexelene™ Tubing cannot be accepted for return due to their third party certifications. Please call before ordering if you have questions about which materials are non-returnable.

Merchandise Return: Contact customer service for an RA number. The RA number must be clearly visible on the outside label of the return carton. Any fittings accepted for return are subject to a 15% minimum restocking fee. The restocking fee will be determined by the Eldon James Customer Service Department.

Limitations of Warranty: Eldon James Corp. warrants its products to be free from defects in materials and workmanship. The exclusive remedy for defective materials or workmanship is limited to replacement of defective products returned to the Eldon James Corp. within sixty days after the invoice and shipping date. NO WARRANTY OF MERCHANTABILITY OR FITNESS IS EXPRESSED OR IMPLIED. There are no warranties which extend beyond the description on the face hereof. Eldon James Corp. is not liable for consequential or other damages, or for any expense incurred through the use of its products. Customers are encouraged to request free samples for testing and evaluation so that the suitability of the product for a particular application may be determined.

International Orders and Shipments:

It is generally easier and more economical to work with a distributor when making purchases outside of the US. Distributors provide value-added customs and freight experience and will often stock requested parts for you.

Special Conditions for International Shipments:

International shipments must be paid for in advance by wire transfer or credit card (authorization is required prior to shipment - see Terms Agreement on preceding page). We ask that you provide Eldon James with your FedEx, UPS, or DHL account number - it is much easier to track a shipment that has a destination freight account when the delivery has reached your country.

Customs: Customs service may delay a shipment by a few days and Customs charges vary considerably between countries. Eldon James provides a commercial invoice and other papers required for international shipments; however, it is the customer's responsibility to pay all customs charges associated with each shipment. These charges are added at the destination. Please check with your country's customs office prior to ordering for information about charges that may be added when your packages are delivered.

Freight Forwarding: Use of a freight forwarding service is recommended for all large shipments. Forwarding services can save shipping costs by combining your order with other deliveries. Freight forwarding companies also have experience in customs clearing and other shipping procedures.

International Distributors



Germany



Sweden



UK - Biotech



UK



Connect 2 Control
New Zealand

Victoria Fittings & Valves

Australia



Germany

**EM-TECHNIK
HOLLAND B.V.**

simply better!

Nederlands

Terms and Conditions of Sale agreement: see preceding page

Eldon James products are available through
these respected partners in the USA

McMASTER-CARR
supply company



US Plastics



HARVARD
APPARATUS



Eldon James Corp.

Eldon James

Loveland CO 80538

Ph. (970) 667-2728 • eldonjames.com • fax (970) 667-3204